

Other Uses and Add-ons:

Macro Arm (M-4): Use the M-4 module for additional versatility in flash positioning. This is especially useful in tricky situations such as shooting from a blind.

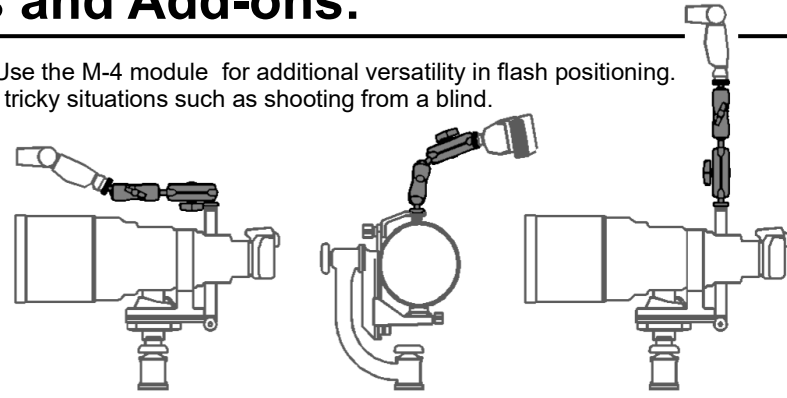

Using the F-4 on the WH-200: The WH-200 has a different dovetail on the arm and thus is not natively compatible with the F-4. To Remedy this, slide the FA-09 onto the arm of the WH-200. The built-in spring design grips the WH-200 Arm so that the FA-09 remains attached when not using a flash bracket.

You may also replace the M-5 Module with an M-9 module that natively works on the WH-200 or the M-1 for use on the sidemount and sidekick heads.

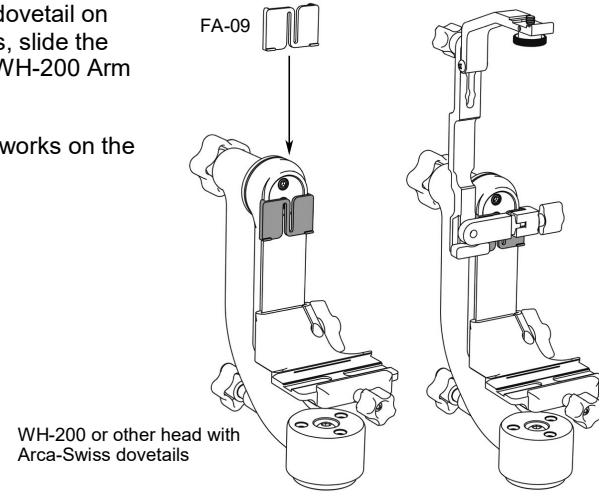

M-6 Extension Post Module:

This post extends the height of your flash by up to 5" which helps reduce red eye or "steel eye" in your people or animal subjects. If you desire more extension, you can stack up to three Extension Posts to get the height you need.

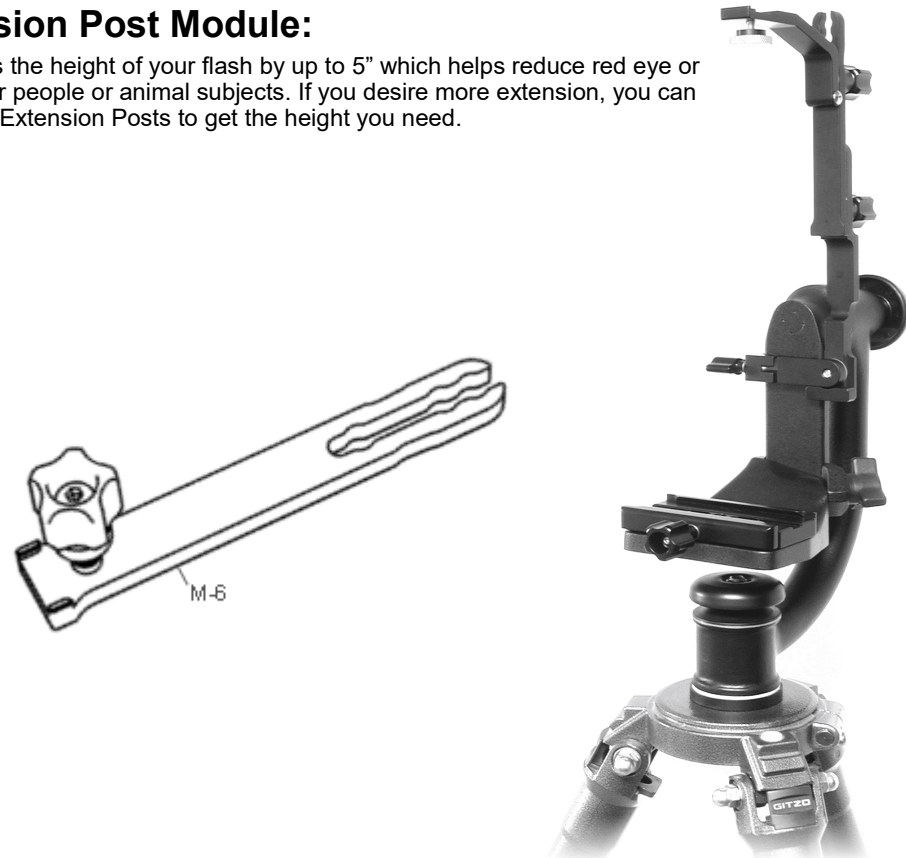

Thank you for your interest in Wimberley products. If you have any questions or comments please feel free to contact us.

F-4 Flash Bracket

7 53182 83449 8

Wimberley

F-4 Old-style Wimberley Head Flash Bracket for WH-100 & WH-101 (Not WH-200)

Package Contents:
M-3 Module: Tilt Arm (Qty 1)
M-5 Module: Old-Style Wimberley Head Quick-release

Made in USA

Dimensions (overall L x W x H): 5.5" x 1.0" x 8.3" In **Weight:** 7.9 oz (224g)

Wimberley, Inc. Phone: 1-434-529-8385
1750 Broadway St Toll Free: 1-888-665-2746 (USA & Canada)
Charlottesville, VA www.tripodhead.com info@tripodhead.com
22902 USA

10 Year Warranty – for details see www.tripodhead.com/warranty.cfm

Attaching the Bracket to the Old-style Wimberley Head:

The F-4 bracket is designed to attach to the swing arm of the original Wimberley Head, version I models WH-100 and WH-101. This bracket can stay on the Head when swapping lenses. It will fit the Arca-swiss dovetails on Wimberley Head Version II (WH-200) if used in conjunction with the FA-09 Flash Bracket Adapter (See last page for more details)

1. Pivot the moving jaw with the knob to either side, perpendicular to the upright portion of the M-5 module. Choose the option that feels best to you and allows you to comfortably access the focusing ring on your lens

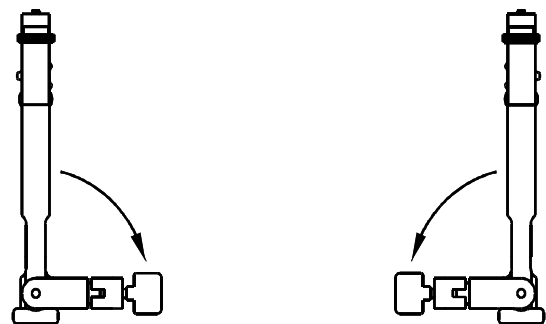

Pivoting arm swings to either side

2. Loosen the bottom knob until it will fit on arm dovetail.
3. Slide the bracket down the swing arm from the top. Turn the wing knob to tighten the clamp jaws and secure the bracket on the swing arm.

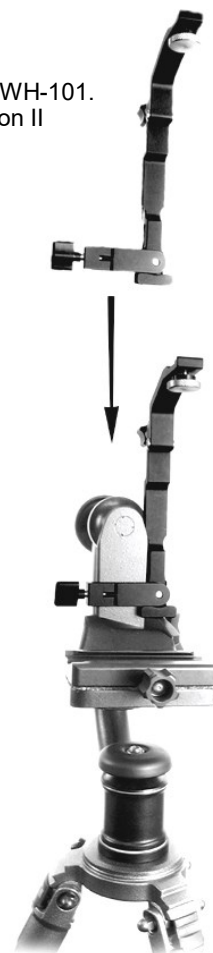

Positioning your Flash:

The Modular Flash Bracket System design allows you to easily disassemble brackets for convenient storage. It also allows you to adjust the size of the bracket to fit different sized lenses using the keyed slots of the upright module to increase or decrease the height of the flash unit. Flip the Tilt Arm upside down to lower the flash even further. When the M-3 is used flipped upside down, the thumb-screw must also be flipped. Below are some of the configurations possible.

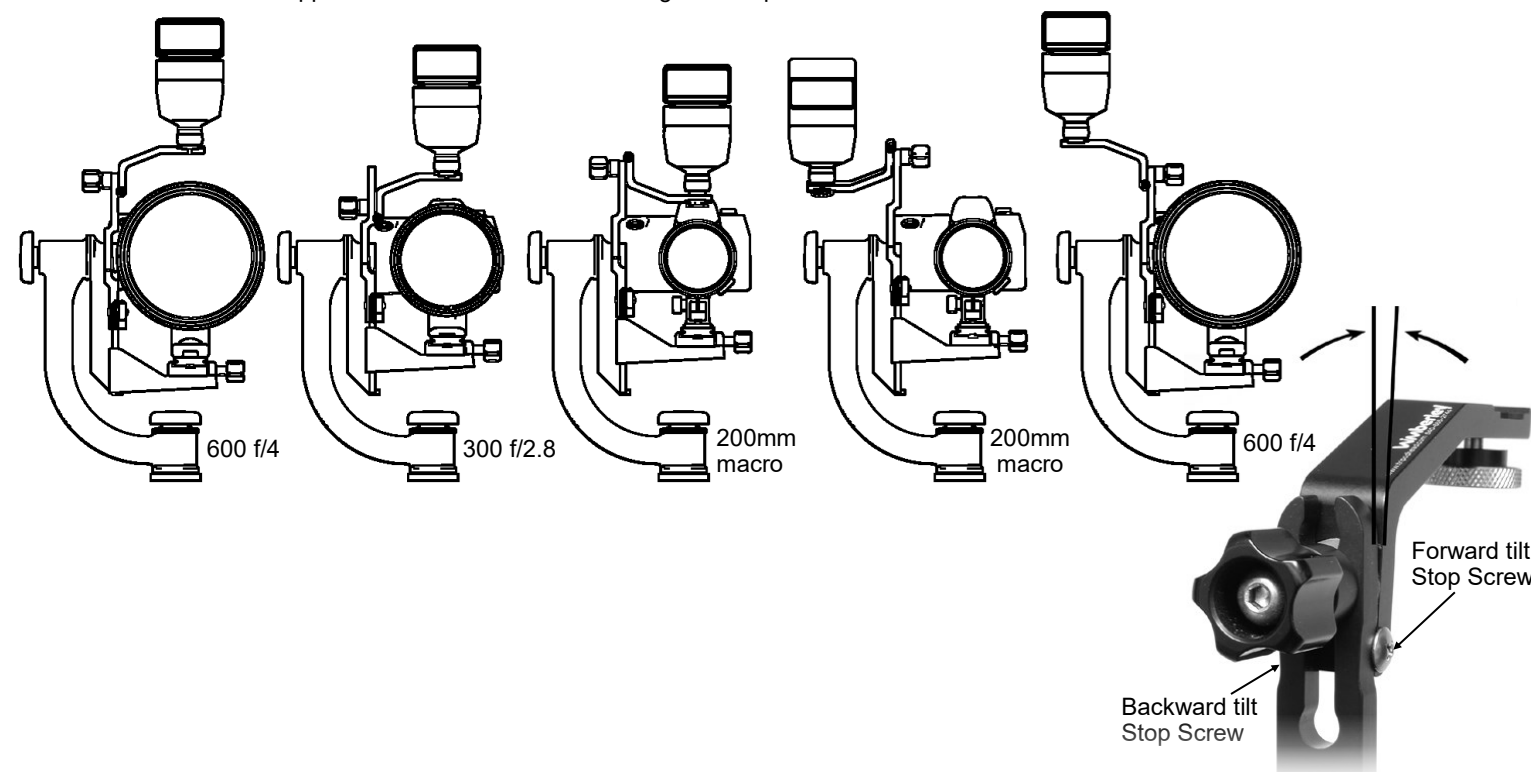

Attaching Your Flash Unit:

Wimberley Flash brackets have a 1/4"-20 mounting thumbscrew that attaches to an off-camera hot shoe cable or a cold shoe adapter such as the Wimberley AP-7. We do not sell flash cords. Please follow camera and flash unit recommendations when purchasing flash cords to ensure proper signal transmission.

Use the thumbscrew on the top of the M-3 Tilt Arm module to attach the shoe. Make sure the flash adapter seats snugly into the bottom notch of the Tilt Arm module. There should be no need to over-tighten.

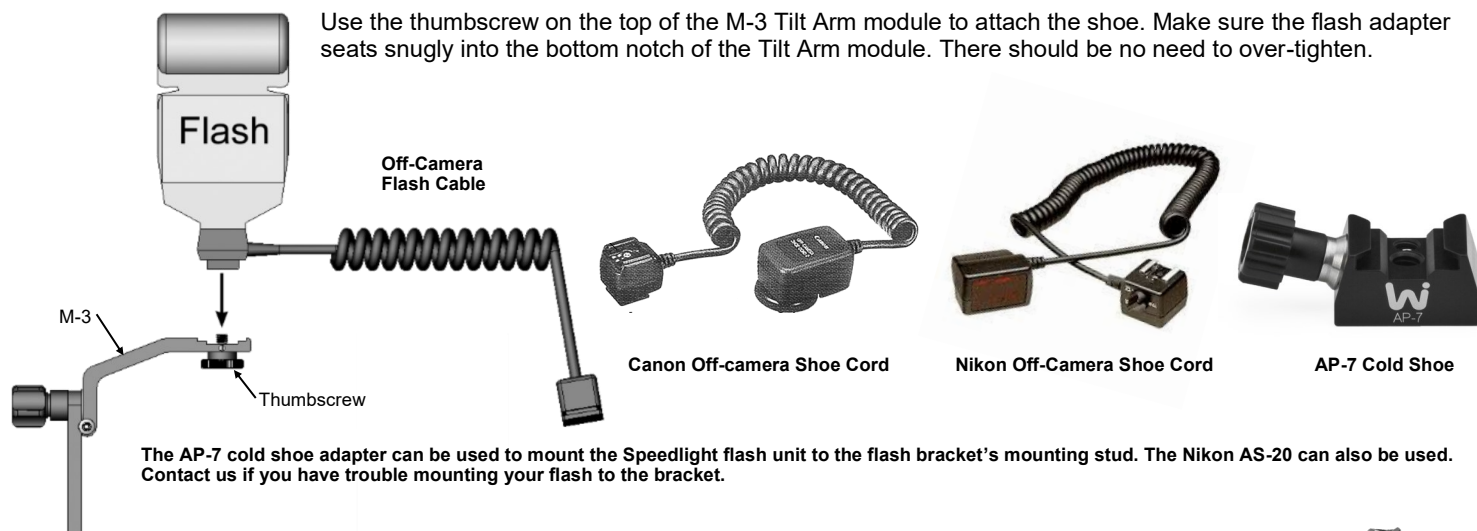

The AP-7 cold shoe adapter can be used to mount the Speedlight flash unit to the flash bracket's mounting stud. The Nikon AS-20 can also be used. Contact us if you have trouble mounting your flash to the bracket.

Nikon SC-29 compatibility note:

The Nikon SC-29 cord requires the use our FA-11 Flash Cord Adapter (sold separately) to attach the cord snugly to the bracket because the cord mounting foot is slightly too wide to fit properly in the slot on the flash arm.

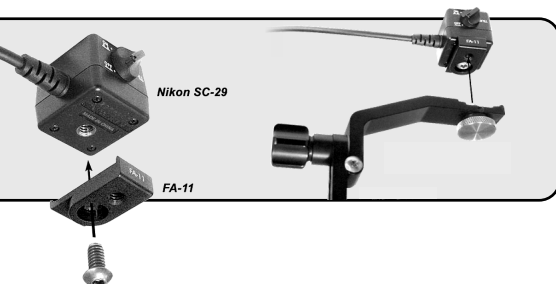

Connecting Flash Bracket Modules:

(The figure below shows the connection between M-3 and upright module; the same principle applies for other module connections.)

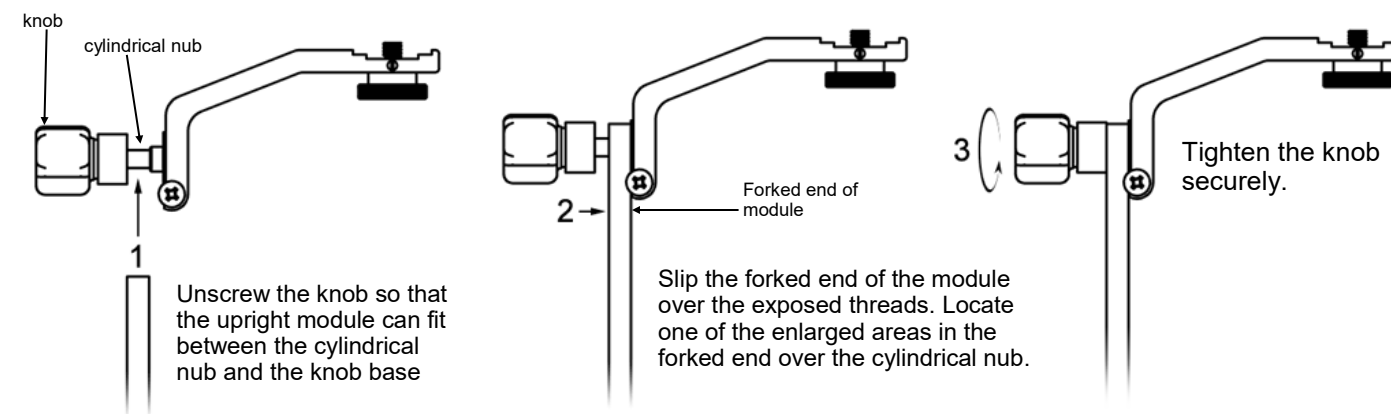

Tip: if you find the metal knobs difficult to grip, try wrapping several layers of self-fusing rubber grip tape (3M 2155) around the knob to cushion it and make it easier to grip in the field.

Feel free to contact us if you have any questions.

