

wimberley®

www.tripodhead.com



Table of Contents

The Wimberley Head Version II[®] - p.4

"The Wimberley Head provides unparalleled freedom of movement when working with large telephoto lenses."

-Art Wolfe



The Sidemount Wimberley Head[™] - p.6

Convert your existing Wimberley Head Version II to the Sidemount version and back again easily. See our new Wimberley Head conversion kits on p.7.

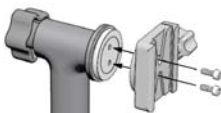

The Sidekick[®] - p.8

"The Sidekick has become my constant companion on photo shoots because for a little more weight, it offers a wide range of new possibilities in wildlife photography."

-Theo Allofs



The Wimberley MonoGimbal Head[™] - p.10

The newest addition to the Wimberley line of Gimbal Heads. This new type of monopod head is specifically designed to balance your long lens on a monopod.



Modular Flash Brackets - p.26-33



"...I don't know of a better bracket system or a more versatile set of brackets to solve any photographic problem."

-George Lepp



Quick-Release Clamps - p.12-13



Universal Camera Body Plate - p.14



Lens Plates - p.16-17



Lens Replacement Feet - p.18-19



Before



After



The Plamp Family - p.34-39

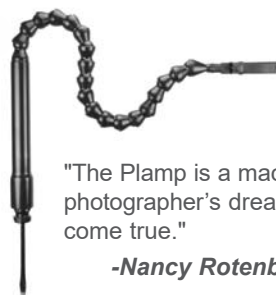

"The Plamp is a macro-photographer's dream come true."

-Nancy Rotenberg

General Information - p.42-43

- About Our Company
- Ordering
- Shipping

- 10 Year Warranty
- Test-Drive Our Products
- Contact Us

The Wimberley Head Version II[®]

WH-200 (\$595.00) — Wimberley Head Version II

Thoughtfully engineered and field tested by the world's top photographers, the Wimberley Head II is the industry standard for long lens support.

The gimbal-type design of the Wimberley Head II allows you to perfectly balance large telephoto lenses (even with flash brackets and teleconverters attached). Once balanced, even the heaviest lenses can be manipulated with fingertip ease. Precision pan and tilt mechanisms provide fluid movement and precise positioning (No annoying shifts in alignment as found in other heads).

Once locked down, *this head is the stiffest in it's class*; other manufacturers often remove material from critical areas, which drastically reduces the overall stiffness of the head. All of the head's knobs are captive. The pan and tilt locking knobs are conveniently located on the same side of the head. "soft-touch" knobs provide a comfortable and secure grip (even when wearing gloves). The Wimberley Head II has a built-in, screw-knob quick-release clamp that assures gear security when used with compatible *Arca-Swiss style plates** (see p.16).

Weight: 3.15 lbs (1430 grams)
Dimensions (L x W x H): 9.3" x 3.5" x 9.9"
Weight Capacity >100lbs (45kg)
(Compatible with the largest lenses in the industry)

Protected by the following Patents: #7478970 & #7600941

Lens Prerequisites:

1- Your lens **must have** a rotation collar _____ if you wish to shoot in both lanscape and portrait.

2- Your lens **must have** an Arca-Swiss style quick-release plate (see note below). _____



***Important Note:** We recommend using a Wimberley Arca-Swiss style plate to insure that the plate's dimensions allow you to properly balance your lens. **Please refer to the charts on pages 20-25.** If you plan to use a plate from a different manufacturer, refer to the charts and compare the dimensions of your existing plate to the one we recommend. Your lens may not balance optimally if the plate you select is too short or dimensionally incompatible.

Lens Size Compatibility

The Wimberley Head will generally work with any lens meeting the above prerequisites and is ideally suited for the largest telephoto lenses (300 f/2.8 and up). Smaller Lenses (e.g. 70-200 f/2.8, 300 f/4), paired with light to medium-weight camera bodies, also work well on the Wimberley Head. However, smaller lenses used in conjunction with a large, heavy camera body (particularly pro bodies with vertical grips), may be impossible to balance perfectly (they are still usable, however you will have to lock the head down when you are not gripping the camera or lens).

"I thought the old Wimberley Head was good. Then I got the new version, which is even better! Great design, easy to use (both knobs on the same side really help), quality fit and finish. You've outdone yourselves on this one."

-John Shaw

"I received my brand new Wimberley V2 head yesterday by Fedex just in time to bring it to Africa... All that I can say is that it is sweet, sweet, sweet..."

-Arthur Morris

"I know I've tried a dozen different tripod heads over the years, but none can compare to the Wimberley."

-Joel Sartore



Accessories & Related Products:

PO-100 Wimberley Head Pouch (\$22.75)

The Wimberley Gimbal Head Pouch fits all versions of our gimbal-style tripod heads, including the Wimberley Head WH-200, WH-200-S, and WH-101. Manufactured by LensCoat®. The soft neoprene protects your gimbal head from scratches while traveling and in the field. A pull-cord closure allows easy access. Fits over gimbal while mounted on tripod and flattens when empty for storage. Available in Black.



F-9 Flash Bracket (\$196.00)

This modular flash bracket attaches directly to the swing arm of the Wimberley Head Version II. It folds flat for storage. In its flat position, it can be used with side-mount gimbal heads such as the Sidekick & Sidemount Wimberley. See p.29 for details.

*Note: This bracket will not fit the original Wimberley Head models (WH-100 & WH-101)** Also, see p.26 for the required adapter for a Nikon SC-29 flash cord.*

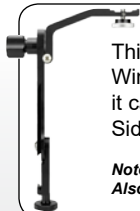

M-8 Perpendicular Plate (\$85.00)

The M-8 Perpendicular Plate allows you to attach your camera body to the Wimberley Head when using non-collared lenses. It attaches at a ninety degree angle to an Arca-swiss style camera body plate. The M-8 provides a dovetail properly oriented to fit in the clamp of the Wimberley Head so your camera faces forward.

Note: The Wimberley Head does not have a 3rd axis for adjusting the horizon, or for flipping the camera for vertical shots. You must level your tripod to ensure that your horizon is level, and vertical shots are only possible if you are using an L-bracket (not available through Wimberley).



RB-100 Riser Block (\$30.00)

For situations where you need a little extra height or extra clearance for the Wimberley Head's lower pan knob. This product raises the height of the Wimberley Head (or any other tripod head) by 1".



The Sidemount Wimberley Head



WH-200-S (\$445.00) — Sidemount Wimberley Head

The Sidemount Wimberley Head is the lighter, more compact alternative to the full Wimberley Head.

The robust main casting, and silky smooth pan and tilt mechanisms are identical to the Wimberley Head II; however, the swing arm and lens support platform are replaced by a side-mounted quick-release clamp. This reduces the head's bulk, and shaves nearly a pound off the weight.

It is simple to convert the gimbal Sidemount Head to the full Wimberley Head or vice versa. Conversion kits for both gimbal head options are available (see "Conversion Kits" on next page).

Weight: 2.3 lbs (1044 grams)
Dimensions (L x W x H): 9.5" x 2.5" x 7.9"
Weight Capacity >100lbs (45kg)
(Compatible with the largest lenses in the industry)

Protected by the following Patents: #7478970 & #7600941

Lens Prerequisites:

- 1- Your lens **must have** a rotation collar _____ if you wish to shoot in both landscape and portrait.
- 2- Your lens **must have** an Arca-Swiss style quick-release plate (see note below). _____



Important Note:

We recommend that you use a Wimberley Arca-Swiss style plate to insure that the plate's dimensions allow you to properly balance your lens (**refer to the charts on pages 20-25**). If you plan to use a plate from a different manufacturer, refer to the charts and compare the dimensions of your existing plate to the one we recommend. Your lens may not balance if the plate you use is dimensionally incompatible.

Lens Size Compatibility

The Sidemount Wimberley Head is ideally suited for lenses ranging in size from a 300 f/2.8 to a 500 f/4. However, many of our customers use smaller or larger lenses with great success.

Smaller Lenses (e.g. 70-200 f/2.8, 300 f/4): Generally, smaller lenses paired with light to medium-weight camera bodies work well. However, when used in conjunction with a large, heavy camera body (particularly pro bodies with vertical grips), these lenses may be impossible to perfectly balance. This is especially true when the additional weight of a flash unit and bracket are attached to the lens plate. The lenses can still be used on the head, however you will have to put some tension on the tilt axis when you are not gripping the lens to keep the set up from flopping.

Larger Lenses (e.g. 600 f/4, 400 f/2.8, 800 f/5.6): The Sidemount Wimberley will safely carry the weight of a very big lens. However, in some cases it is necessary to reduce the profile of the lens (distance between the lens foot and the lens barrel) by replacing the factory foot on the rotation collar with a lower-profile foot. **Use the charts on pages 20-25 to determine if your lens is compatible with the Sidemount Wimberley.** If you cannot find your lens on the charts, or have other questions, please give us a call and we'll be glad to help.

Sidemount vs. Full Wimberley Head

Because the Sidemount and the Wimberley Head share identical pan and tilt mechanisms, the basic feel and function of the two heads is identical. The Sidemount has the advantage of being lighter weight (2.3 lbs vs. 3.15 lbs), less expensive (\$445 vs. \$595), and slightly more compact. It is also nominally stiffer than the full Wimberley Head.

The full Wimberley Head has an adjustable lens support platform, which allows it to accommodate some lenses that will not work with the Sidemount. This vertical adjustment also allows you to compensate for the top-heavy weight of a flash unit, allowing you to perfectly balance your lens even when using an off-camera flash (typically attached to a flash bracket). When using flash with the Sidemount, the rig will always be slightly top-heavy. It will still be easy to control, but not as nicely as when the set-up is perfectly balanced. Although many prefer the full Wimberley Head, many of our customers find themselves in situations where a lighter-weight gimbal head would be desirable.



We offer two conversion kits (see below) to ensure that you can choose the right set-up for any situation.

Using Telephoto Flash: Wimberley Head (F-9) vs. Sidekick (F-6) Bracket

Because the attachment point of a Wimberley quick-release flash bracket is along the exposed portion of the quick-release lens plate, the Sidemount Wimberley Head can accommodate two different Wimberley Modular Flash Bracket configurations. If you already use the Wimberley Head Version II, or plan to upgrade to the full gimbal head in the future, we recommend choosing the F-9 Wimberley Head Version II flash bracket (p. 5 & 29) to use with the Sidemount Head.

If you already own the F-1 Telephoto or F-6 Sidekick bracket, you can use the Sidekick bracket configuration with the Sidemount Wimberley

Gimbal Head Conversion Kits

It is simple and quick to convert an existing Wimberley Head Version II to the Sidemount version and vice versa: it simply requires removing two screws. Current Wimberley Head users can easily switch their existing heads to a Sidemount and back again depending on their needs. For photographers reluctant to commit to a full Wimberley Head, purchasing the less expensive Sidemount creates an easy transition step.

Sidemount Conversion Kit

(CK-100) - \$79.00

This kit allows you to replace the swing arm and support platform of the Wimberley Head Version II (WH-200) with a side-mounted quick-release clamp. The procedure is simple and the only tool required is a hex key (included).

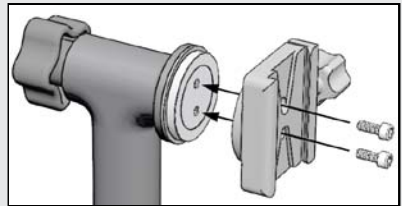

Full Gimbal Conversion Kit

(CK-200) - \$229.00

This kit allows you to replace the quick-release clamp of the Sidemount Wimberley Head with a swing arm and lens support platform to form the Full Wimberley Head (WH-200). The procedure is simple, and the only tool required is a hex key (included).

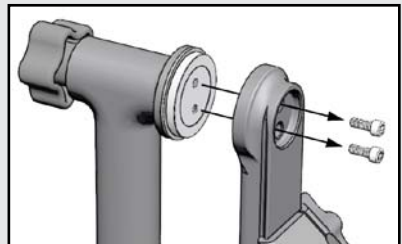

Note: The CK-200 is not compatible with the Sidekick.

The Sidekick®

The Sidekick SK-100 (\$250.00)

At 1.3 pounds and small enough to be easily packed, the Wimberley Sidekick converts an Arca-Swiss compatible ball head into a gimbal head in seconds.

Simply slide the Sidekick into the quick-release clamp of your ball head. The Sidekick's elevated tilt mechanism and side-mounted clamp allow the lens to rotate around its center of gravity. This provides the same action and ease of use found in the full Wimberley Head at a reduced size, weight and cost*. Remove the Sidekick, and your ball head is ready to use with smaller lenses.

Weight: 1.3 lbs (590 grams)
Weight Capacity >100lbs (45kg)
(Limited to Ballhead Panning Capacity)
Dimensions: 9" x 5" x 2.5"

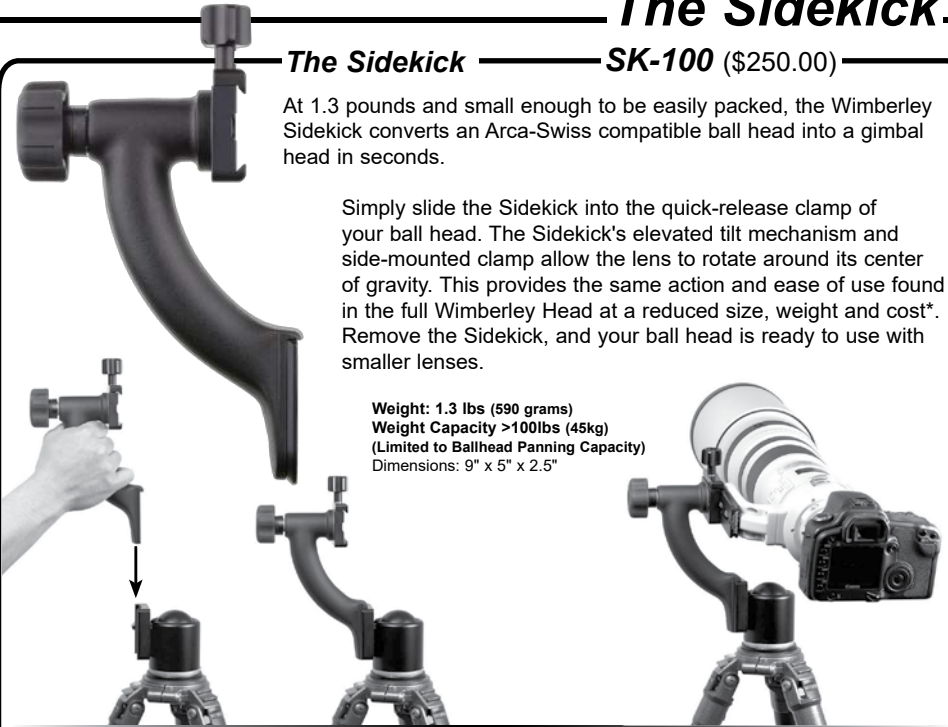

***Important Note:** the smoothness of panning action relies on the quality of ball head you have and its ability to handle a side load. Use of a high-quality ball head is required, especially if you plan to use heavy lenses with the Sidekick (see ball head requirements on p.9). Contact us for ball head recommendations.

Lens Prerequisites:

- 1- Your lens **must have** a rotation collar.
- 2- Your lens **must have** an Arca-Swiss style quick-release plate (see note below)



Important Note:

We recommend that you to use a Wimberley Arca-Swiss style plate to insure that it is long enough to properly balance your lens (**refer to the charts on pages 20-25**). If you plan to use a plate from a different manufacturer, refer to the charts to see if your plate is similar to the one we recommend, and to see if you need any additional components when using the Sidekick. Your lens may not balance if the plate you use is dimensionally incompatible.

Lens Size Compatibility

The Sidekick is ideally suited for lenses ranging in size from a 300 f/2.8 to a 500 f/4. However, many customers report using smaller or larger lenses with great success.

Smaller Lenses (e.g. 70-200 f/2.8, 300 f/4): Generally, smaller lenses that are paired with light to medium-weight camera bodies work well. However, these lenses can be difficult to balance properly when used with a large, heavy camera body (particularly pro bodies with vertical grips).

Larger Lenses (e.g. 600 f/4, 400 f/2.8, 800 f/5.6): The Sidekick will safely carry the weight of a very big lens provided it is used with a heavy-duty ball head that will hold the weight of the lens. However, in some cases it is necessary to replace the factory foot of the lens with a lower-profile one and/or add spacer components to make the lens dimensionally compatible. **Use the charts on pages 20-25 to determine if your lens is compatible with the Sidekick, and if there are any special adapters needed.** If you cannot find your lens on the charts, please give us a call and we'll be glad to help.

"...stable, fast and wonderfully light. It's a great asset for fast-moving action photography."

-Daniel J. Cox

Product Improvement!

Integrated Anodized QR Plate

The Original Sidekick had cnc machined cast surfaces powdercoated as a whole including the arca-swiss dovetail mounting surfaces. We removed a little material from the casting and added an anodized cnc-machined plate that can hold the tolerances required by common lever-lock QR clamps.

With this improvement, all Wimberley products now are natively lever-lock compatible. We have also added an optional but recommended safety stop screw to prevent dumping.



Ball Head Requirements:

1- Your ball head must be able to hold the weight of your lens without creeping or slipping.

2- Your ball head must have an Arca-Swiss style quick-release clamp (e.g. Arca-Swiss, Kirk, Really Right Stuff, Markins, Acratech).

Note: Most Gitzo and Manfrotto ball head clamps are not compatible with the Sidekick mounting geometry.

3- Your ball head must have a panning base with a separate knob that can be locked independently of the ball and socket joint.



BH-300 (\$445.00)

The BH-300 combines the industry standard Arca Swiss Z-1 Ballhead and a Wimberley C-10 QR Clamp. This pair is a good example of a high quality ballhead for use with the Wimberley Sidekick.

Dimensions:
4.2"H x 3.6"L x 2.7"W
Weight: 24.4 oz

Accessories & Related Products:

PO-120 Sidekick Pouch (\$22.75)

This protective pouch was designed for the Wimberley Sidekick and manufactured by LensCoat®. The soft neoprene protects your gimbal head from scratches while traveling and in the field. A pull-cord closure allows easy access. Fits over your gimbal while mounted on tripod and flattens when empty for storage. Available in black.



F-6 Flash Bracket (\$152.00)

This modular flash bracket positions the flash above the lens when using the Sidekick, Wimberley Sidemount, MonoGimbal or other side-mount gimbal head. It attaches to an Arca-Swiss lens plate (see p.29).

Note: If you want a bracket that will work with the Sidekick, for hand-held work, and also with your ball head, choose the F-1 Telephoto Bracket that can be configured for each one of these tasks.

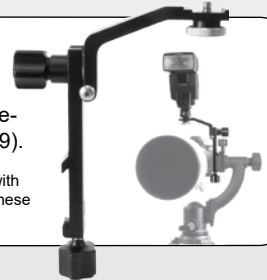

"The Wimberley Sidekick is a very important accessory that makes photographing action in the field with long lenses an easier task. I simply add the Sidekick to my ball head and immediately have a gimbal-type head that has smooth movements in every direction. The fact that the Sidekick is small and lightweight and still allows me to use the ball head for other types of photography is a real advantage."

The Wimberley MonoGimbal Head™

MH-100 (\$179.00)



At .77 pounds and small enough to be easily packed, the Wimberley MonoGimbal is the first head to offer designated gimbal functionality on your monopod.

Unlike traditional monopod heads, there is no tendency to buckle or flop (even with the controls loose, and no hands on the camera or lens).

The MonoGimbal allows easy tracking of moving subjects without having to support the weight of the lens. Whether you are hiking or making your way through a crowd, the offset nature of the head turns your monopod into a convenient multi-position carry handle.

Weight: .77 lbs (350 Grams)
Weight Capacity >100lbs (45kg)
(Compatible with the largest lenses in the industry)

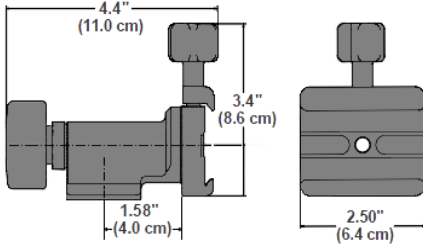

Monopod Requirements:

- 1- Your Monopod should have a 3/8" Mounting stud and a weight capacity of about 3 or more times the weight of your setup.
- 2- Optional: If you wish to Mount using the Arca-Swiss dovetails you must have an Arca-Swiss style quick-release clamp (see pg 12)

Lens Prerequisites:

- 1- Your lens **must have** a rotation collar.
- 2- Your lens **must have** an Arca-Swiss style quick-release plate (see note below)



We recommend that you use a Wimberley Arca-Swiss style plate to insure that it is long enough to properly balance your lens (refer to the charts on pages 20-25).

***Important Note:** the smoothness of use depends significantly on the quality of the lens collar and its ability to handle a side load. If your lens does not work well in this configuration, please contact us so that we may assist further on possible fixes or return of the head if no fix exists and the lens in question is why you purchased the head. We have heard of isolated incidences of a couple of lenses not rotating smoothly, but these seem to be on older lenses and it is suspected that lubrication is the issue.

We are very interested in feedback about your lenses operation in conjunction with this head.

The MonoGimbal features anodized cnc-machined arca-swiss dovetails that match the tolerances required by common lever-lock QR clamps. This allows you to quickly connect and disconnect your MonoGimbal from an Arca-Swiss style compatible clamp attached to the monopod.

Integrated Arca-Swiss Style Dovetails

3/8-16" Stainless Threaded Insert

Safety Stop Screw Mounts

If you choose to mount to your monopod using the integrated Arca-Swiss dovetails, We recommend installing the optional safety stop screws (included) to prevent dumping.



Accessories & Related Products:

PO-130 MonoGimbal Pouch (\$22.75)

This protective pouch was designed for the Wimberley MonoGimbal Head and manufactured by LensCoat®. The soft neoprene protects your gimbal head from scratches while traveling and in the field. A pull-cord closure allows easy access. Fits over gimbal while mounted on monopod, and flattens when empty for storage. Available in black.



F-6 Flash Bracket (\$152.00)

This modular flash bracket positions the flash above the lens when using the MonoGimbal, Sidekick, Wimberley Sidemount, or other side-mount gimbal head. It attaches to an Arca-Swiss lens plate (see p.29).

Note: If you want a bracket that will work with the MonoGimbal, for hand-held work, and also with your ball head, choose the F-1 Telephoto Bracket that can be configured for each one of these tasks.

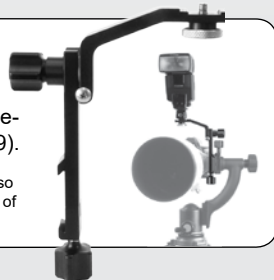

Quick-Release Clamps

Wimberley quick-release (QR) clamps use the Arca-Swiss geometry. They accept Wimberley QR plates, as well as a wide variety of Arca-Swiss style plates made by other manufacturers.

Note: not compatible with most Gitzo or Manfrotto quick-release plates.



Clamp Width: 2.5"
Weight: 4.5 oz

C-12 (\$79.00)

The geometry of the C-12's mounting holes, combined with the large selection of included fasteners, allow you to securely attach this quick-release clamp to a much wider variety of equipment than any other clamp on the market. The C-12's screw-knob clamping mechanism accepts a wide variety of plate widths, providing a secure way to mount your expensive gear.

Included Hardware:

- (1) M6 x 30mm Flat Head Screw
- (1) 1/4-20 x 3/4" Flat Head Screw
- (3) M3 x 12mm Screws
- (1) 2.5mm Hex Key
- (1) 5/32 Hex Key
- (1) 3/8" to 1/4" Brass Reducer Bushing



For specific information regarding compatible ball heads, please visit our website:

<http://www.tripodhead.com/products/C12-compatibility.cfm>

Features

Tongue-in-pocket Design

Our clamps have a unique tongue-in-pocket design that protects internal parts from dust and grit.

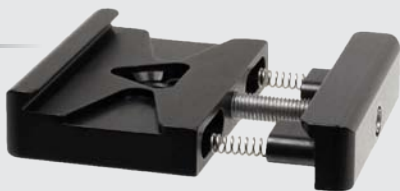

The tongues are nearly twice as long as those on conventional Arca-Swiss style clamps. This added length counteracts the tendency of the moving jaw of the clamp to hinge backward during clamping, keeping the jaws aligned with the geometry of the plate. This eliminates unwanted bending stress on the threaded stud.

Captive Knob

A captive knob is designed in such a way that the user cannot accidentally remove the knob during use. There is a stop screw located on the end of the stud to keep the knob from unscrewing from the threaded stud.



Our clamps are constructed of 6061 Aluminum and stainless steel.

C-30 (\$100.00)



This quick-release clamp was made for use with the original Wimberley Head (WH-100 & WH-101). It attaches to the old style Wimberley Head's lens support platform* with two stainless steel screws (included).

The C-30 features three 3/8" tapped holes, which can be used for a variety of mounting configurations**.

***Note:** The Wimberley Head Version II™ (WH-200) has a built-in quick-release clamp and does not need the C-30.

Clamp Width: 4.2"
Weight: 7.5 oz

Included Hardware:

- (2) 3/8-16 x 5/8" Button Head Cap Screw
- (2) 3/8 Washers
- (1) 7/32 Hex Key



****Note:** The added length of the C-30 clamp (1.7" longer than the C-12) provides a negligible amount of added functionality for the majority of uses. For most applications, we recommend using the lighter and less expensive C-12 clamp. We are still manufacturing the C-30 for those who wish to upgrade a non-quick-release Wimberley Head, replace a damaged clamp on their Wimberley Head version I, or have an application that requires a slightly longer clamp.

Safety Channels

Two shallow channels extend from the sides of the clamp and stop just short of the central tapped hole.



These channels allow greater fore-aft adjustment when using the safety stops on Wimberley and other compatible Arca-Swiss style quick-release plates (see p.16).



Universal Camera Body Plate

P-5 (\$52.00)

The P-5 is a simple Arca-Swiss style universal plate that provides the same high quality of construction, solid connection and anti-twist characteristics of custom plates.

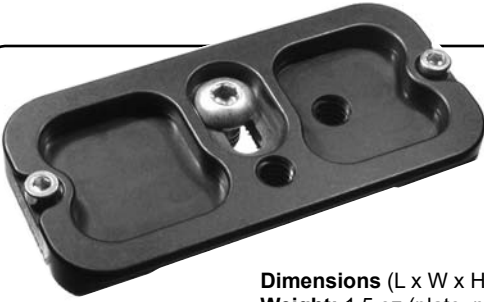

Dimensions (L x W x H): 3.0" x 1.5" x 0.35"

Weight: 1.5 oz (plate, mounting screw & 2 stop screws)

Features

Universal Design

- No need to buy a new plate when you buy a new camera.
- Use the P-5 on your camera with or without the vertical grip attached.
- Use the P-5 for backup camera bodies, even medium format cameras.

Dual Safety Stops

The P-5 features the same dual safety stops found on our lens plates (p.16).

Note: This feature is not compatible with the newer Arca-Swiss "double-decker" or stacked-groove clamps. If this safety feature is important to you, see p.12 for a compatible replacement clamp.

Ergonomics

The P-5's thin profile and generously rounded corners make it easy on the hands; it blends beautifully with the contours of your camera.



How does it work?

The P-5 features a thin layer of dense high friction, rubber on its top surface. This layer grips the bottom of your camera, but is so dense and thin that it maintains the solid feel of a metal-to-camera connection. We use high quality self-adhesive 3M rubber that is designed for the long haul.

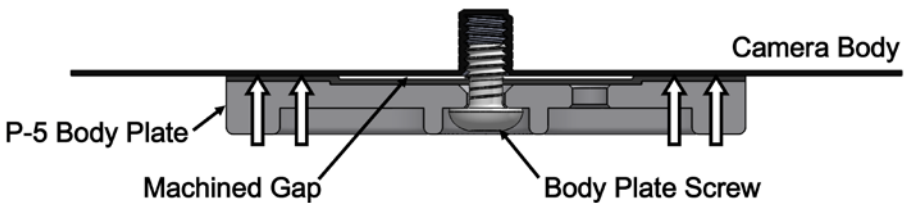

Beneath the rubber, the top surface of the plate is machined with a shallow cutout in the center to ensure that the frictional force is concentrated on the outer portions of the plate. This provides the maximum mechanical advantage to resist twisting while providing a flex-resistant, solid connection.

Compatibility

The P-5 will work on nearly any camera body. It is best suited for high-end cameras that have metal skeletons and metal threads. It will also perform well on less expensive, plastic-bodied cameras, but it is important to use caution and not over-tighten the plate on these cameras (see warning below). The universal design of the P-5 allows you to use it for many other applications as well (camcorders, point-and-shoot cameras, etc.)

Note: The P-5 plate is *not compatible* with Canon PowerShot Pro-1 or Panasonic DMC-FZ50 Lumix.

A word of Warning

Universal camera body plates such as the P-5 require that you tighten the plate snugly to your camera body to ensure that they do not twist. The design of the P-5 resists twisting with *minimal* clamp force; however, caution must be exercised when using any plate on camera bodies that do not have a metal skeleton, and especially those with plastic threads.

Lens Plates

We offer a line of quality Arca-Swiss style quick-release plates for the attachment of lenses with tripod mounting feet to our quick-release clamps. All plates include enough hardware for attachment to most lenses. The charts on pp. 20-25 specify recommended plates for the most popular lenses on the market today.

P-10 (\$52.00)	2 mount screws, anti-twist nubs (L x W x H): 3.31" x 1.5" x 0.38" 2.3 oz (Kit = plate, 2 plate screws, & 4 stop screws)
P-20 (\$52.00)	2 mount screws, anti-twist nubs (L x W x H): 3.86" x 1.5" x 0.38" 2.7 oz (Kit = plate, 2 plate screws, & 4 stop screws)
P-30 (\$55.00)	2 mount screws, anti-twist nubs (L x W x H): 4.43" x 1.5" x 0.38" 3.2 oz (Kit = plate, 2 plate screws, & 4 stop screws)
P-35 (\$56.00)	3 mount screws, 1 bushing (L x W x H): 5.0" x 1.5" x 0.38" 3.3 oz (Kit = plate, 3 plate screws, & 4 stop screws)
P-40 (\$58.00)	3 mount screws, 1 bushing (L x W x H): 5.88" x 1.5" x 0.38" 4.5 oz (Kit = plate, 3 plate screws, 4 stop screws)
P-50 (\$58.00)	3 mount screws, 1 bushing (L x W x H): 6.58" x 1.5" x 0.38" 4.8 oz (Kit = plate, 3 plate screws, 4 stop screws)

Lens Plate Dimensions

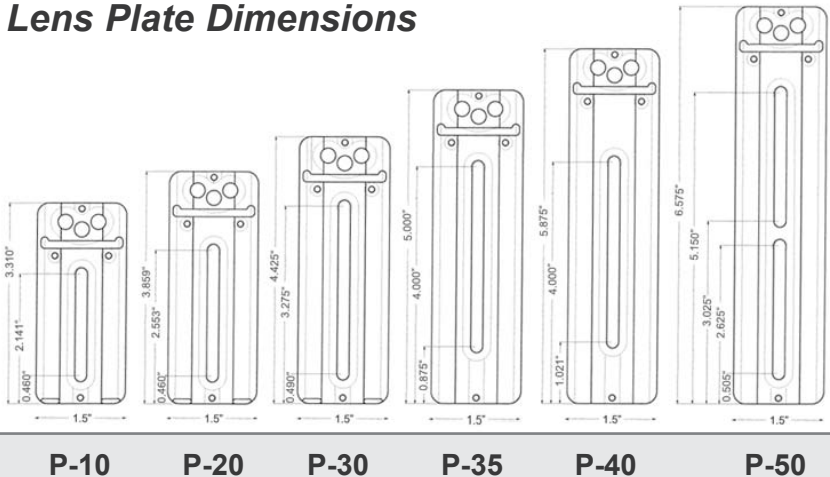



The "Arca-Swiss Style" Quick-Release Geometry refers to the open-cavity dovetail quick-release system developed decades ago by Arca-Swiss for use with their Monoball ball heads and large format cameras. After the extreme popularity of the Arca-Swiss B-1 ball head in the 1990s, other companies began manufacturing custom camera-body and lens plates using this geometry. Since then, this geometry has become the industry standard for high-end tripod heads (particularly in the nature photography industry).

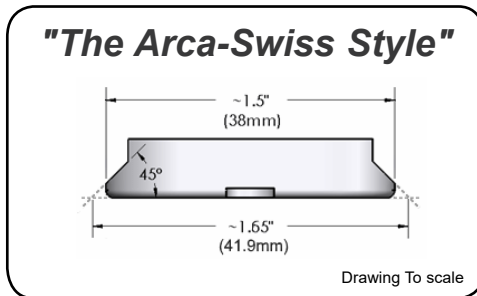

The Wimberley Head Version II, Sidekick, and other clamps use this quick-release system, so any lens that you wish to connect to our heads must be equipped with an Arca-Swiss style lens plate or replacement foot.

Manufacturers that use compatible Arca-Swiss Style Quick-Release Geometry include: Acratech, Arca-Swiss, Foba, Giottos (only on their most recent line of ball heads & plates), Hejnar, Jobu, Kirk, Markins, Novoflex (only on some of their products), Promediagear, Really Right Stuff, Studioball, and Wimberley.

Not all of these manufacturers maintain tolerances necessary for popular lever-lock clamps. All Wimberley dovetails comply strictly to the arca-swiss style shown above.

Features

Dual Safety Stops

Our revolutionary safety stops at the front and back of our plates keep your expensive lens from accidentally slipping out of compatible Arca-Swiss style quick-release clamps. You may choose to use both, only one, or neither of these stops.

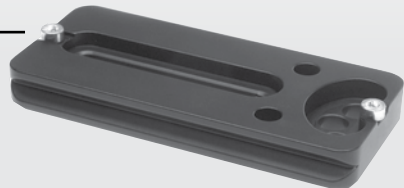

Anti-twist Nubs

The P-10, P-20, and P-30 plates have anti-twist nubs at the back of the plate. These help to keep the plate from twisting if it is mounted with only one fastener. Our trend-setting design performs better than a continuous single flange when butted against a curved surface. (**Note:** The P-40 and P-50 plates do not have anti-twist nubs because they are usually attached with more than one screw.)



Double-dovetail Cross Section

Our double-dovetail design, now an industry standard, allows you to attach Wimberley quick-release flash brackets (pg. 26) to the upper and/or lower surface of the plate.

Flash Bracket Versatility

In addition to accepting Wimberley quick-release flash brackets, the three holes at one end of our plates allow the attachment of older RRS & Kirk screw-mount brackets.

Lens Replacement Feet

These custom, low-profile replacement feet lower the center of gravity of large lenses - necessary for optimal balance on our gimbal heads - and make them easier to pack. Each replacement foot has double-dovetail grooves to serve as the quick-release (QR) plate for the lens, so an additional lens plate is not needed.

Our replacement feet have the same dual safety stops and flash bracket compatibility as our lens plates. They also have 1/4" and 3/8" tapped holes for mounting to non-quick-release tripod heads and monopods. All tools needed to remove your existing lens foot are included.



Lens Compatibility Drawings

Accurate compatibility and fit drawings are available for each replacement foot and corresponding compatible lenses.

See tripodhead.com/products/replacement-feet-main.cfm

Canon 400 f/2.8 IS III
with AP-601 Replacement Foot

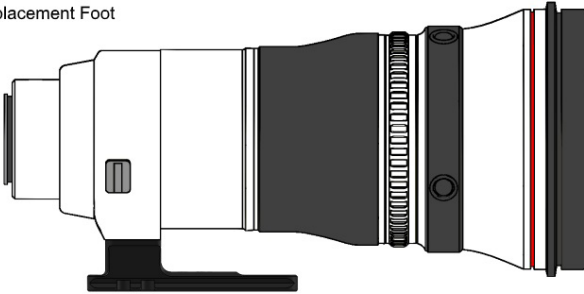

Canon 400 f/2.8 IS III
with factory foot and hood reversed

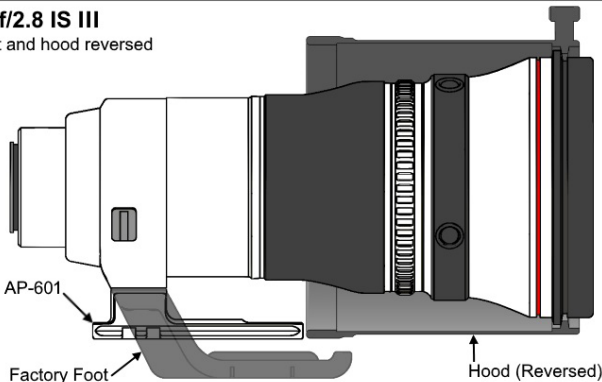



See chart starting on next page for applicable lenses.

Nikon

Canon / Sigma

Sony

(\$79.00)
AP-452



(\$59.00)
AP-500



(\$59.00)
AP-501



(\$100.00)
AP-502



(\$100.00)
AP-551



(\$75.00)
AP-552



(\$100.00)
AP-554



(\$120.00)
AP-555



(\$100.00)
AP-600



(\$100.00)
AP-601



(\$79.00)
AP-602



(\$100.00)
AP-603



(\$110.00)
AP-604



(\$49.00)
AP-607



(\$100.00)
AP-608



(\$79.00)
AP-609



(\$59.00)
AP-610



(\$59.00)
AP-611



(\$79.00)
AP-616



(\$79.00)
AP-620



Lens Plate Recommendations

About this Guide:

The charts below (and continued on the next pages) list the lens plate and additional hardware (if necessary) that we recommend for some of the most common collared lenses. If your lens is not on the list, please contact us and we will be happy to help you find the proper plate.

We try to suggest a plate that will work for all scenarios, but this is not always possible. The balance point of the lens/camera combination is effected by the weight of the camera body and other accessories attached to the lens and each set up is different.

The plates that we recommend should be long enough to: 1.) properly balance the lens when using our gimbal heads, and 2.) allow room to attach a flash bracket to the plate. In some cases, this means that the plate is significantly longer than the foot of the lens.

NOTE: Other manufacturer's plates may not be long enough or dimensionally compatible in order to properly balance your setup. Check the length of the recommended plate in our charts for comparison. If your particular setup does not balance properly using our suggested plate, please contact us right away so that we can help you find a more suitable plate.

Miscellaneous parts referred to in chart

SW-100 Extra Screw (\$1.00)

1/4-20 x 1/2" (.5) Custom Stainless Captive Hex Button Head Cap Screw (5/32" hex drive)

For lenses that require more screws than are included with plate.

See p.16 for the number of screws included with each plate.

(Note: screw is not compatible with the P-5 Camera Body Plate.)



SS-100 Spotting Scope Screw (\$1.00)

1/4-20 x 7/16" (.44) Custom Stainless Captive Hex Button Head Cap Screw (5/32" hex drive)

For spotting scopes and some Fuji, Olympus and Panasonic lenses that require a shorter screw.

(Note: screw is not compatible with the P-5 Camera Body Plate.)



BS-100 Brass Reducer Bushing (\$3.00)

Lens feet with 3/8" mounting holes require insertion of a 3/8" to 1/4" reducer bushing.

Our P-40 and P-50 lens plates come with a brass reducer bushing included in the kit. There is no need to order an additional bushing unless your lens foot has more than one 3/8" size hole. See p.16.



Sidekick Shifter & Spacers

Sidekick Shifters (AP-900 through AP-903) attach to the bottom of the Sidekick to properly adjust the lateral position of the lens's center of gravity.

Refer to the charts above to see if your lens requires the use of these spacers.

AP-900 (\$50) Sidekick Shifter Block = 0.75" offset

AP-901 (\$65) Sidekick Shifter + one (1/4") spacer plate = 1.0" offset

AP-902 (\$80) Sidekick Shifter + two spacer plates = 1.25" offset

AP-903 (\$95) Sidekick Shifter + three spacer plates = 1.50" offset



Can't find your lens on the charts?

Please visit our website (www.tripodhead.com/products/lens-plates-main.cfm)

or contact us for plate recommendations for lenses not listed here.

Canon Lenses	Wimberley Head (WH-200) Non-Gimbal Heads (Ball Heads, etc.)	Sidekick (SK-100)	Sidemount Wimberley (WH-200-S)
65 2.8 1-5x Macro	P-20	P-20	P-20
100 2.8 Macro IS & non-IS	P-20	P-20	P-20
180 3.5 Macro	P-20	P-20	P-20
28-300 3.5-5.6 IS	P-20	P-20	P-20
35-350 3.5-5.6 IS	P-20	P-20	P-20
70-200 2.8 non-IS	P-20	P-20	P-20
70-200 2.8 IS	P-20	P-20	P-20
70-200 2.8 IS II & IS III	P-10	P-10	P-10
70-200 2.8 IS RF	P-20	P-20	P-20
70-200 4.0 non-IS & IS I&II	P-10	P-10	P-10
70-300 4.0-5.6 IS	P-20	P-20	P-20
80-200 2.8	P-20	P-20	P-20
100-300 2.8 IS RF	P-35 or AP-601	AP-601	AP-601
100-400 4.5-5.6 IS	P-20	P-20	P-20
100-400 4.5-5.6 IS II	P-10 Mounted in reverse	P-10 Mounted in reverse	P-10 Mounted in reverse
100-500 4.5-7.1 IS RF	P-20 Mounted in reverse or AP-607	P-20 in reverse or AP-607	P-20 in reverse or AP-607
200 1.8	P-20	P-20	P-20
200 2.0 IS (I & II)	P-20	P-20	P-20
200-400 4.0 IS Ext 1.4	P-40 or AP-603	P-40 + AP-900 or AP-603	P-40 or AP-603
300 2.8 non-IS	P-20	P-20	P-20
300 2.8 IS I	P-30	P-30	P-30
300 2.8 IS II	P-20 or AP-603	P-20 or AP-603	P-20 or AP-603
300 4.0 non-IS	P-10	P-10	P-10
300 4.0 IS	P-20	P-20	P-20
400 2.8 non-IS	P-50	P-50 + AP-900	not compatible
400 2.8 IS (I & II)	P-40 or AP-604	AP-602*	AP-602*
400 2.8 IS (III & RF)	P-40 or AP-601	AP-601	AP-601
400 4.0 DO IS I	P-20	P-20	P-20
400 4.0 DO IS II	P-20 or AP-603	P-20 or AP-603	P-20 or AP-603
400 5.6	P-20	P-20	P-20
500 4.0 IS I	P-40	P-40	P-40
500 4.0 IS II	P-40 or AP-603	AP-603	AP-603
500 4.5 non-IS	P-40	P-40	P-40
600 4.0 non-IS	P-50	P-50 + AP-900	not compatible
600 4.0 IS I	P-40 or AP-604	(P-40 + AP-902) or AP-602*	P-40 or AP-602*
600 4.0 IS II	P-40 or AP-604	(P-40 + AP-901) or AP-602*	P-40 or AP-602*
600 4.0 IS (III & RF)	P-40 or AP-600	AP-600	AP-600
600 4.5 (Manual Focus)	P-50	P-50	P-50
600 11 RF	P-35	P-35	P-35
800 5.6 IS	P-40 or AP-608	AP-608	AP-608
800 5.6 IS RF	P-40 or AP-601	AP-601	AP-601
800 5.6 (Manual Focus)	P-50	P-50	P-50
800 11 RF	P-30	P-30	P-30

*This foot mounts very close to the lens, making it difficult to use as a handle. See Compatibility Drawings on our website

Fuji Lenses	Wimberley Head (WH-200) Non-Gimbal Heads (Ball Heads, etc.)	Sidekick (SK-100)	Sidemount Wimberley (WH-200-S)
50-140 2.8 WR	P-10*	P-10*	P-10*
100-400 4.5-5.6 WR	P-30*	P-30*	P-30*

*This foot has shallow mounting holes and requires an additional fastener, The shorter SS-100 Spotting Scope Screw.

...Lens Plate Recommendations (continued)

Nikon Lenses	Wimberley Head (WH-200) Non-Gimbal Heads (Ball Heads, etc)	Sidekick (SK-100)	Sidemount Wimberley (WH-200-S)
70-180 4.5-5.6 AF Macro	P-10	P-10	P-10
200 4.0 (Ai-S & AF) Macro	P-10	P-10	P-10
70-200 2.8 VR (I & II)	P-20	P-20	P-20
70-200 2.8 E FL VR	P-20	P-20	P-20
70-200 2.8 Z S-line	P-20 or AP-501*	P-20 or AP-501*	P-20 or AP-501*
70-200 4.0 AF-S VR	P-20	P-20	P-20
80-200 (2.8 AF & AF-S)	P-10	P-10	P-10
80-400 4.5-5.6 AF VR	P-10	P-10	P-10
80-400 4.5-5.6 AF-S VR	P-10	P-10	P-10
100-400 4.5-5.6 Z S-line	P-20 or AP-501*	P-20 or AP-501*	P-20 or AP-501*
180-400 4.0 FL VR TC 1.4	P-40 or AP-551	AP-551	AP-551
200-400 4.0 VR (I & II)	P-40 or AP-551	AP-551	AP-551
200-500 5.6 E VR	P-30	P-30	P-30
200 2.0 Ai & Ai-S	P-10	P-10	P-10
200 2.0 VR (I & II)	AP-552	AP-552	AP-552
300 2.8 Ai-S & Ai	P-10	P-10	P-10
300 2.8 (AF & AF-I)	P-20	P-20	P-20
300 2.8 AF-S (I & II)	P-30	P-30	P-30
300 2.8 VR (I & II)	P-30 or AP-551	AP-551	AP-551
300 4.0 (AF & AF-S)	P-10	P-10	P-10
300 4.0 E PF VR	P-20	P-20	P-20
300 4.5 Ai-S	P-10	P-10	P-10
400 2.8 Ai-S & AF-I	P-50	P-50 + AP-903	not compatible
400 2.8 AF-S (I & II)	AP-452 (Mandatory on WH-200)	AP-452	AP-452
400 2.8 VR (I & II)	AP-452 (Mandatory on WH-200)	AP-452	AP-452
400 2.8 FL VR	P-40 or AP-555	AP-555 + AP-900	not compatible
400 2.8 TC Z S-line	P-40 or AP-502	AP-502	AP-502
400 3.5 (Manual Focus)	P-30	P-30	P-30
400 4.5 Z S-line	P-20 or AP-501*	P-20 or AP-501*	P-20 or AP-501*
400 5.6 Ai-S	P-20	P-20	P-20
500 5.6 PF VR	P-20 or AP-500	P-20 or AP-500	P-20 or AP-500
500 4.0 Ai P	P-30	P-30	P-30
500 4.0 AF-I	P-40	P-40 + AP-902	not compatible
500 4.0 AF-S (I & II)	P-40 or AP-554	AP-554	AP-554
500 4.0 VR (I & II)	P-40 or AP-554	AP-554	AP-554
500 4.0 FL VR	P-40 or AP-551	AP-551	AP-551
600 4.0 Ai-S	P-50	P-50 + AP-900	not compatible
600 4.0 AF-I	P-50	P-50 + AP-902	not compatible
600 4.0 AF-S I	AP-652	AP-652 + AP-900	not compatible
600 4.0 AF-S II	AP-452 (Mandatory on WH-200)	AP-452	AP-452
600 4.0 VR (I & II)	AP-452 (Mandatory on WH-200)	AP-452	AP-452
600 4.0 FL VR	P-50 or AP-555	AP-555 + AP-901	not compatible
600 4.0 TC Z S-line	P-40 or AP-502	AP-502	AP-502
600 5.6 Ai-S	P-30	P-30	P-30
800 5.6 (Manual Focus)	P-50	P-50 + AP-900	not compatible
800 5.6 FL VR	P-40 or AP-555	AP-555 + AP-901	AP-555
800 6.3 Z S-line	P-30 or AP-502	AP-502	AP-502

*This foot mounts very close to the lens, making it difficult to use as a handle. See Compatibility Drawings on our website

Can't find your lens on the charts?

Please visit our website (www.tripodhead.com/products/lens-plates-main.cfm)
or contact us for plate recommendations for lenses not listed here.

Konica Minolta	Wimberley Head (WH-200) Non-Gimbal Heads (Ball Heads, etc)	Sidekick (SK-100)	Sidemount Wimberley (WH-200-S)
70-200 2.8 APO SSM	P-10 + BS-100	P-10 + BS-100	P-10 + BS-100
80-200 2.8 APO	P-10 + BS-100	P-10 + BS-100	P-10 + BS-100
300 2.8 APO G D SSM	P-20 + BS-100	P-20 + BS-100	P-20 + BS-100
400 4.5 APO G	P-10 + BS-100	P-10 + BS-100	P-10 + BS-100
600 4 APO G	P-50	P-50	P-50

Olympus (ZUIKO/ M.ZUIKO Lenses	Wimberley Head (WH-200) Non-Gimbal Heads (Ball Heads, etc)	Sidekick (SK-100)	Sidemount Wimberley (WH-200-S)
35-100 2.0 Zuiko	P-20	P-20	P-20
40-150 2.8 M.Zuiko	P-10*	P-10*	P-10*
50-200 2.8-3.5 Zuiko	P-20	P-20	P-20
90-250 2.8 Zuiko	P-40	P-40	P-40
150 2.0 Zuiko	P-20	P-20	P-20
300 2.8 Zuiko	P-30	P-30	P-30
300 4.0 M.Zuiko	P-20	P-20	P-20

*This foot has shallow mounting holes and requires an additional fastener, The shorter SS-100 Spotting Scope Screw.

Panasonic Lenses	Wimberley Head (WH-200) Non-Gimbal Heads (Ball Heads, etc)	Sidekick (SK-100)	Sidemount Wimberley (WH-200-S)
100-400 4.0-6.3	P-30*	P-30*	P-30*

*This foot has shallow mounting holes and requires an additional fastener, The shorter SS-100 Spotting Scope Screw.

Miscellaneous parts referred to in chart

SW-100 Extra Screw (\$1.00)

1/4-20 x 1/2" (.5) Custom Stainless Captive Hex Button Head Cap Screw (5/32" hex drive)

For lenses that require more screws than are included with plate.

See p.16 for the number of screws included with each plate.

(Note: screw is not compatible with the P-5 Camera Body Plate.)



SS-100 Spotting Scope Screw (\$1.00)

1/4-20 x 7/16" (.44) Custom Stainless Captive Hex Button Head Cap Screw (5/32" hex drive)

For spotting scopes and some Fuji, Olympus and Panasonic lenses that require a shorter screw. (Note: screw is not compatible with the P-5 Camera Body Plate.)



BS-100 Brass Reducer Bushing (\$3.00)

Lens feet with 3/8" mounting holes require insertion of a 3/8" to 1/4" reducer bushing.

Our P-40 and P-50 lens plates come with a brass reducer bushing included in the kit. There is no need to order an additional bushing unless your lens foot has more than one 3/8" size hole. See p.16.



Sidekick Shifter & Spacers

Sidekick Shifters (AP-900 through AP-903) attach to the bottom of the Sidekick to properly adjust the lateral position of the lens's center of gravity.

Refer to the charts above to see if your lens requires the use of these spacers.

AP-900 (\$50) Sidekick Shifter Block = 0.75" offset

AP-901 (\$65) Sidekick Shifter + one (1/4") spacer plate = 1.0" offset

AP-902 (\$80) Sidekick Shifter + two spacer plates = 1.25" offset

AP-903 (\$95) Sidekick Shifter + three spacer plates = 1.50" offset



...Lens Plate Recommendations (continued)

Pentax Lenses	Wimberley Head (WH-200) Non-Gimbal Heads (Ball Heads, etc)	Sidekick (SK-100)	Sidemount Wimberley (WH-200-S)
60-250 4.0 SMC DA	P-20	P-20	P-20
80-200 2.8 SMC FA	P-20	P-20	P-20
150-450 4.5-5.6 D-FA AW	P-40	P-40	P-40
200 4.0 Macro SMC A	P-20	P-20	P-20
250-600 5.6 SMC P-FA	P-50	P-50	P-50
300 2.8 SMC P-A (MF)	P-20	P-20	P-20
300 2.8 AF SMC P-FA	P-30	P-30	P-30
300 4.0 SMC-DA	P-30	P-30	P-30
400 2.8 SMC A	P-30	P-30	P-30
560 5.6 DA AW	P-50	P-50	P-50
600 4.0 SMC P-FA	P-50	P-50	P-50

Sigma Lenses	Wimberley Head (WH-200) Non-Gimbal Heads (Ball Heads, etc)	Sidekick (SK-100)	Sidemount Wimberley (WH-200-S)
Lens with a TS-41 Collar & foot	P-40	P-40	P-40
50-500 4.5-6.3 APO	P-40	P-40	P-40
70-200 2.8 APO	P-10	P-10	P-10
70-200 2.8 DG OS Sports	P-10	P-10	P-10
60-600 4.5-6.3 DG OS Sports	P-30	P-30	P-30
80-200 2.8	P-10	P-10	P-10
80-400 4.5-5.6 APO OS	P-40	P-40	P-40
100-300 4.0 APO	P-10	P-10	P-10
105 1.4 Art	P-20	P-20	P-20
120-300 2.8 DG	P-30	P-30	P-30
120-300 2.8 DG OS	P-30	P-30	P-30
120-300 2.8 DG OS Sports	P-40	P-40	P-40
120-400 4.5-5.6 DG OS	P-30	P-30	P-30
135-400 4.5-5.6	P-10	P-10	P-10
150 2.8 OS Macro	P-20	P-20	P-20
150-500 5-6.3 APO	P-50	P-50	P-50
150-600 5.0-6.3 Contemporary	P-30	P-30	P-30
150-600 5.0-6.3 Sports	P-50 or AP-608	P-50 or AP-608	P-50 or AP-608
170-500 5.0-6.3 APO	P-10	P-10	P-10
180 2.8 OS Macro	P-10	P-10	P-10
300 4.0	P-10	P-10	P-10
300 2.8 APO	P-20	P-20	P-20
300-800 5.6 APO	P-50	P-50 + AP-900	not compatible
400 5.6 APO	P-10	P-10	P-10
500 4.0 OS Sports	P-50 (or AP-602)	P-50 (or AP-602)	P-50 (or AP-602)
500 4.5 non-HSM	P-30	P-30 + AP-900	not compatible
500 4.5 APO	P-50	P-50 + AP-900	not compatible
800 5.6 APO	P-50	P-50 + AP-900	not compatible

Sony Lenses	Wimberley Head (WH-200) Non-Gimbal Heads (Ball Heads, etc)	Sidekick (SK-100)	Sidemount Wimberley (WH-200-S)
28-135 4.0 FE PZ G OSS	P-20 + BS-100	P-20 + BS-100	P-20 + BS-100
70-200 2.8 G SSM I & II	P-20 + BS-100	P-20 + BS-100	P-20 + BS-100
70-200 2.8 GM OSS	P-10 or AP-611*	P-10 or AP-611*	P-10 or AP-611*
70-200 4.0 G OSS	P-20 + BS-100	P-20 + BS-100	P-20 + BS-100
70-400 4-5.6 G SSM I & II	P-20 + BS-100	P-20 + BS-100	P-20 + BS-100
100-400 4.5-5.6 FE GM OSS	P-20 or AP-610*	P-20 or AP-610*	P-20 or AP-610*
200-600 5.6-6.3 FE G OSS	P-35 or AP-620	P-35 or AP-620	P-35 or AP-620
300 2.8 G SSM I & II	P-30 + BS-100	P-30 + BS-100	P-30 + BS-100
400 2.8 GM OSS	P-40 or AP-609	AP-609	AP-609
500 4.0 G SSM	P-40	P-40	P-40
600 4.0 FE GM OSS	P-35 or AP-616	AP-616	AP-616

*This foot mounts very close to the lens, making it difficult to use as a handle. See Compatibility Drawings on our website

Can't find your lens on the charts?

Please visit our website (www.tripodhead.com/products/lens-plates-main.cfm)
or contact us for plate recommendations for lenses not listed here.

Tamron Lenses	Wimberley Head (WH-200) Non-Gimbal Heads (Ball Heads, etc.)	Sidekick (SK-100)	Sidemount Wimberley (WH-200-S)
70-200 2.8 Di VC	P-20	P-20	P-20
70-200 2.8 AF Macro	P-20	P-20	P-20
70-210 2.8	P-10 + BS-100	P-10 + BS-100	P-10 + BS-100
180 3.5 AF Macro	P-10	P-10	P-10
150-600 5-6.3 VC	P-30	P-30	P-30
150-600 5-6.3 VC G2	P-30	P-30	P-30
200-400 5.6	P-10	P-10	P-10
200-500 5-6.3	P-10	P-10	P-10
300 2.8	P-20	P-20	P-20

Tokina Lenses	Wimberley Head (WH-200) Non-Gimbal Heads (Ball Heads, etc.)	Sidekick (SK-100)	Sidemount Wimberley (WH-200-S)
50-135 2.8	P-10	P-10	P-10
70-200 4.0	P-20	P-20	P-20
80-200 2.8	P-10	P-10	P-10
80-400 4.5-5.6	P-20	P-20	P-20
100-300 4.0 APO	P-10	P-10	P-10
100-400 4.0 APO	P-10	P-10	P-10
150-500 5.6	P-20	P-20	P-20
300 2.8	P-20	P-20	P-20
300 4.0	P-10	P-10	P-10
400 5.6 APO	P-10	P-10	P-10

Miscellaneous parts referred to in chart

SW-100 Extra Screw (\$1.00)

1/4-20 x 1/2" (.5) Custom Stainless Captive Hex Button Head Cap Screw (5/32" hex drive)

For lenses that require more screws than are included with plate.

See p.16 for the number of screws included with each plate.

(Note: screw is not compatible with the P-5 Camera Body Plate.)



SS-100 Spotting Scope Screw (\$1.00)

1/4-20 x 7/16" (.44) Custom Stainless Captive Hex Button Head Cap Screw (5/32" hex drive)

For spotting scopes and some Fuji, Olympus and Panasonic lenses that require a shorter screw. (Note: screw is not compatible with the P-5 Camera Body Plate.)



BS-100 Brass Reducer Bushing (\$3.00)

Lens feet with 3/8" mounting holes require insertion of a 3/8" to 1/4" reducer bushing.

Our P-40 and P-50 lens plates come with a brass reducer bushing included in the kit. There is no need to order an additional bushing unless your lens foot has more than one 3/8" size hole. See p.16.



Sidekick Shifter & Spacers

Sidekick Shifters (AP-900 through AP-903) attach to the bottom of the Sidekick to properly adjust the lateral position of the lens's center of gravity.

Refer to the charts above to see if your lens requires the use of these spacers.

AP-900 (\$50) Sidekick Shifter Block = 0.75" offset

AP-901 (\$65) Sidekick Shifter + one (1/4") spacer plate = 1.0" offset

AP-902 (\$80) Sidekick Shifter + two spacer plates = 1.25" offset

AP-903 (\$95) Sidekick Shifter + three spacer plates = 1.50" offset



Modular Flash Bracket System

Our flash brackets attach to Arca-Swiss style plates. (Not compatible with most Gitzo & Manfrotto plates.)

Flash Brackets



Telephoto Brackets — p.28

- F-1 Telephoto Bracket
- F-6 Sidekick Bracket
- F-9 Wimberley Head II/Sidemount Bracket



Macro Brackets — p.30

- F-2 Macro Bracket
- Dual Macro Flash Setups



Other Applications — p.32

- Quick-Flip Portrait/Wedding Bracket
- Bean Bag Support Setup (bean bag not included)

Module 1 --- M-1 Quick-Release Arm (\$66.00)

Attaches to most Arca-Swiss style quick-release plates (details on p.33). Used in F-1, F-2 & F-6 flash brackets.



Module 2 --- M-2 Upright (\$44.00)

This is the vertical upright for the F-1 Telephoto Bracket combo (p.28).



Module 3 --- M-3 Tilt Arm (\$86.00)

Serves as the tiltable attachment point for your flash for telephoto brackets (p.28). Used in F-1, F-4, F-6 & F-9 flash brackets.



Requires flash cord or a wireless flash and the AP-7 Cold Shoe.
NOTE: Nikon SC-29 flash cord requires FA-11 Adapter (p.28).

"These flash brackets are the best system I've encountered for doing macro flash afield and for doing tele-flash work. That's quite a statement."

-Joe McDonald

Quick-Release Attachment

Our flash brackets feature a low-profile, Arca-Swiss style quick-release clamp. This makes setting up your flash a breeze. No tools needed and no screws to lose. See p.33 for details.



Modular Design = Possibilities

Our unique modular design allows you add components and reconfigure your brackets to meet nearly any photographic need. The components of the system connect to one another simply and securely without tools. Connections are solid and cannot twist, creep or slip apart. All knobs are captive.

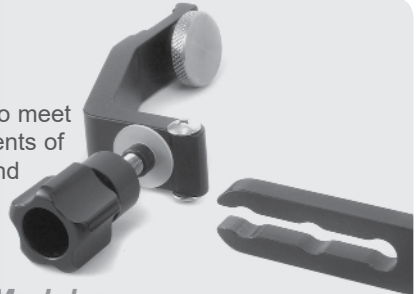

Individual Modules

Module 4 --- M-4 Macro Arm (\$103.00)

Extremely positionable arm for macro brackets or advanced telephoto work. Redesigned to be 26% lighter with the same holding capacity.

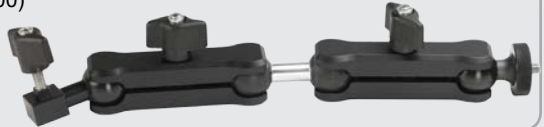

Module 6 --- M-6 Extension Post (\$43.00)

Add this module to any of our telephoto brackets to increase the height of your flash to reduce eye shine in animal subjects (details on p.28).



Module 7 --- M-7 Flash Flipper (\$89.00)

Add this to the F-1 Telephoto Bracket to easily flip your flash for vertical or horizontal shots. Terrific for wedding or portrait work (details on p.32).



Module 8 --- M-8 Perpendicular Plate (\$85.00)

Allows you to attach the F-1 Telephoto Bracket or multiple F-2 Macro Brackets to your camera body (details on p.31).

Note: use in conjunction with the P-5 Camera Body Plate to attach your camera with a non-collared lens to the Wimberley Head. See p.5 for details.



Module 9 --- M-9 Wimberley Head Version II™ Module (\$110.00)

Serves as the upright and quick-release for the F-9 Wimberley Head Version II™ Bracket (p.29).



Telephoto Brackets

Note: All brackets require the use of an off-camera shoe cord or a wireless flash and the AP-7 Cold Shoe. If using the **Nikon SC-29** flash cord, the FA-11 flash adapter is required.

F-1 Telephoto Bracket (\$196.00)

This bracket consists of modules **M-1, M-2 & M-3**

The most versatile of our telephoto brackets, the F-1 attaches to most Arca-Swiss style quick-release plates on any lens. It can be used when shooting hand-held, with a ball head or the Wimberley Head.

Remove the M-2 Module to configure it for use with the Sidekick, Sidemount Wimberley or other side-mount gimbal head. Add the M-4 Module to this bracket for macro capability. Add the M-7 Module to form a quick-flip portrait and wedding bracket.

Weight: 9.4 oz.

Dimensions (L x W x H): 5.63" x 1.0" x 9.13"

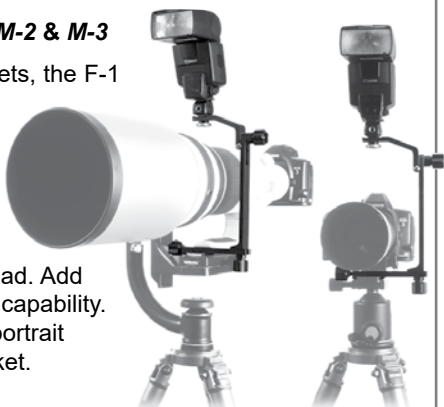

Useful Add-Ons

FA-11 Flash Adapter (\$19.00)

The FA-11 adapter allows you to attach the **Nikon SC-29** flash cord to the M-3 Module of any telephoto bracket.

Note: This adapter is not required for the SC-28 cord.

Adapter attaches to the cord's hot-shoe with stainless steel screw (included)



M-6 Extension Post (\$43.00)

Add the M-6 Module to flash bracket to increase the height of your flash, which reduces red-eye or "steel-eye" in your animal subjects.

The Extension Post gives you 5" of added height. For even more height, you can connect multiple posts in a series. Posts can be used vertically or horizontally (to extend out a window or blind). Pairs fit together for compact storage.

Anti-twist nubs lock the Extension Post in the vertical position so that it cannot flop or creep. The unique geometry of this module allows you to accurately tilt your flash 3 degrees to compensate for the added flash height when shooting close subjects.



F-6 Sidekick Bracket (\$152.00)

This bracket consists of modules **M1 & M3**

It positions the flash above the lens when using the Sidekick, Wimberley Sidemount, or other side-mount gimbal head. It attaches to an Arca-Swiss lens plate (see p.33). If you desire full gimbal-to-Sidemount conversion flexibility, see the F-9 bracket below.

Note: If you want a bracket that will work with the Sidekick, for hand-held work, and also with your ball head, choose the F-1 Telephoto Bracket that can be configured for each one of these tasks.

Weight: 6.0 oz

Dimensions (L x W x D): 5.7" x 1.0" x 6.7"



F-9 Wimberley Head Version II Bracket (\$196.00)

This bracket consists of modules **M3 & M9** It attaches directly to the arca-swiss dovetails on the swing arm of the Wimberley Head Version II. Since it is attached to the head and not your lens, it remains in place when you switch lenses.

The F-9 also works with the **Wimberley Sidemount & the Sidekick.**

Note: This bracket will not work with the original Wimberley Head models (WH-100 & WH-101).

Weight: 6.5 oz

Dimensions (L x W x H): 5.5" x 1.0" x 8.5"

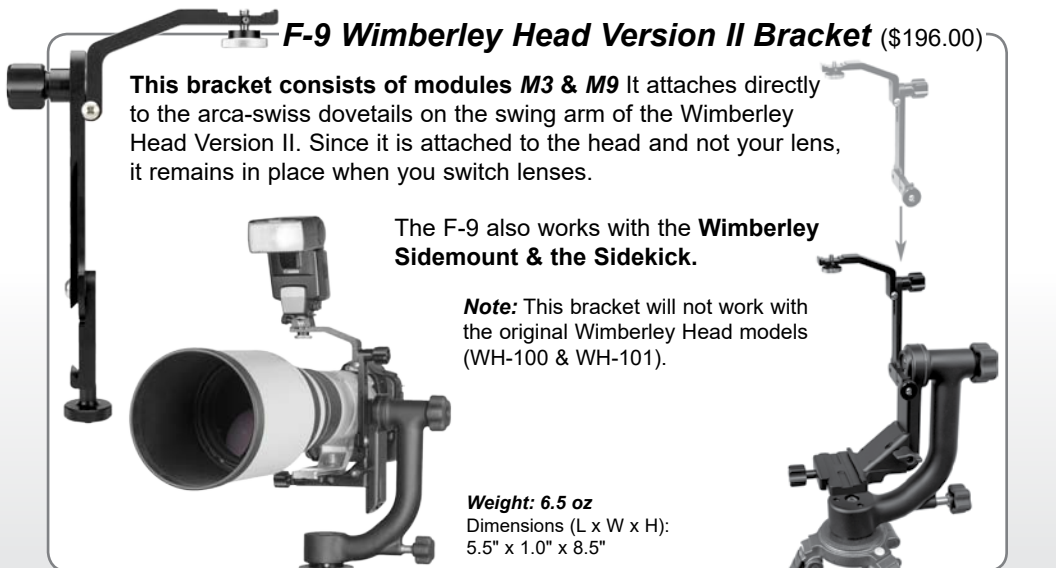

Captive Knob
(Nylon)

Anti-Rotation
Set screw

AP-7 Cold Shoe (\$19.00)

The AP-7 allows you to attach a flash directly to a flash bracket for wireless applications. This adapter is a universal cold shoe adapter compatible with most flashes and off-camera flash cables.

Not compatible with OEM or 3rd Party Sony Flashes.

The cold shoe features an anti-rotation set screw to orient your flash or cold shoe accessory.

Includes:

Coldshoe
1/4-20 Thumbscrew
Anti-Rotation Set Screw
Hex Key for Set Screw

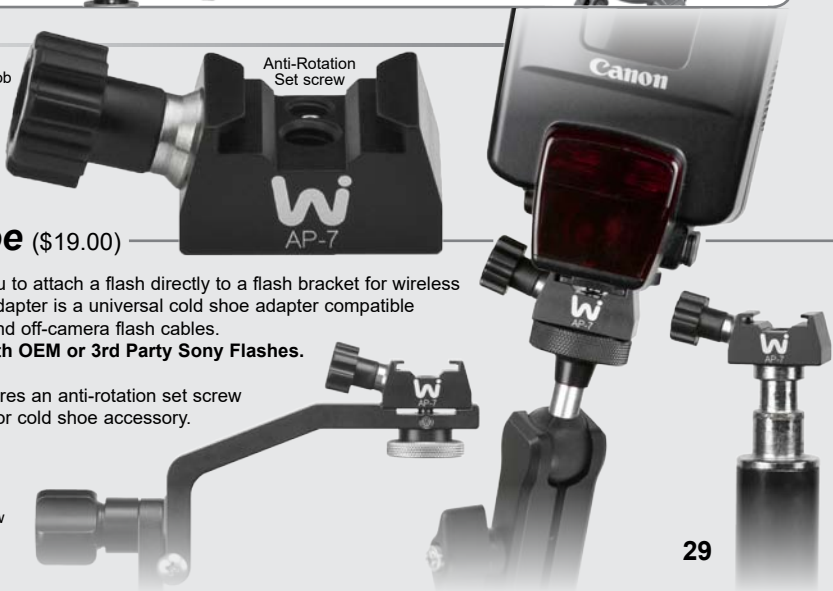

Macro Brackets

F-2 Macro Bracket (\$169.00)

This bracket consists of modules *M-1* & *M-4*

The articulating arm on this bracket is comprised of two double ball and socket links that lock positively and offer a great range of flash positions. The bracket attaches quickly to your Arca-Swiss style lens plate or camera body plate with a low-profile quick-release clamp (see p.33). The F-2 attaches to an off-camera shoe cord or cold shoe with a standard 1/4-20 stud. You will want to make sure that your existing plates are long enough to accommodate this bracket. Adding the M-8 Perpendicular Plate (p.31) makes it more convenient to use this bracket on your camera body. This bracket was recently redesigned and is now 21% lighter with the same holding capacity.

Weight: 11.4 oz (322 grams)

Dimensions Folded (L x W x H): 5.5" x 4.25" x 2.25"

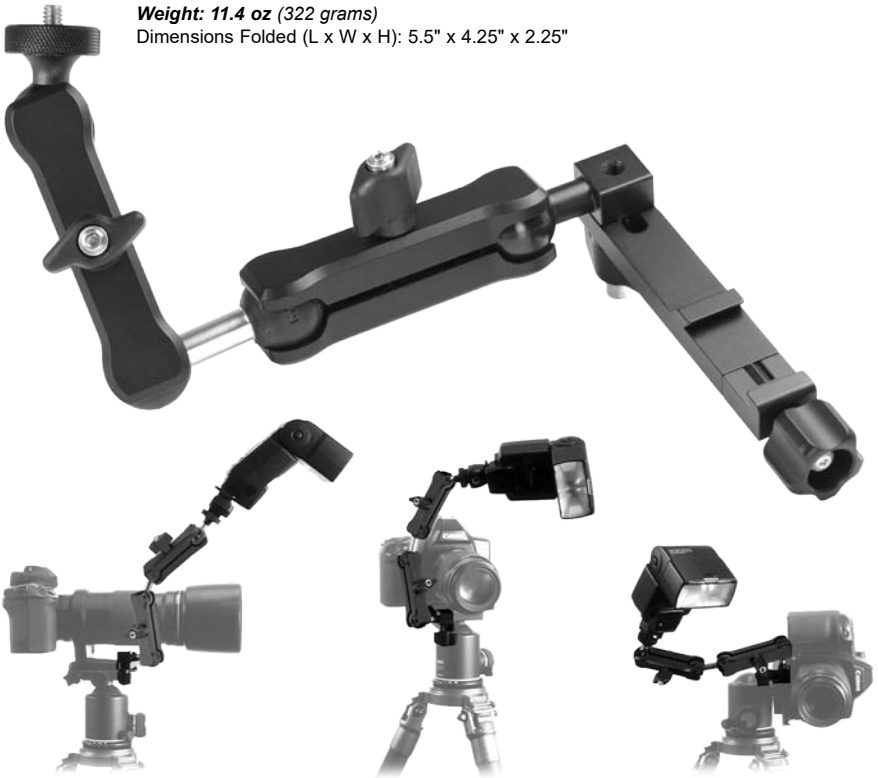

on Lens Plate

on Camera Plate

on Camera Plate

Note: requires the use of an off-camera shoe cord or a wireless flash and the AP-7 Cold Shoe.

"I have used many macro brackets in my time, starting with one I made myself from aircraft aluminum over 20 years ago. Yours is easily the best on the market. Most 'new' accessories are just permutations of things already done - your bracket is a true innovation and a significant step forward. Thanks."

-Michael Lustbader

Dual Flash Setups

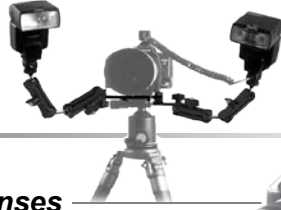

Dual Flash Macro Setup: Collared Lenses

For this setup you will need:

- Two F-2 Macro Brackets
- Lens plate for your lens

To use two flashes on a collared lens, such as a 100mm macro, attach two F-2 Brackets to a double-dovetail, Arca-Swiss style lens plate on your lens foot (see right). You will need to use a plate with sufficient length to attach both brackets (see p.33). Our double-dovetail plates allow you to attach one bracket to the top surface of the plate, and one to the bottom surface.

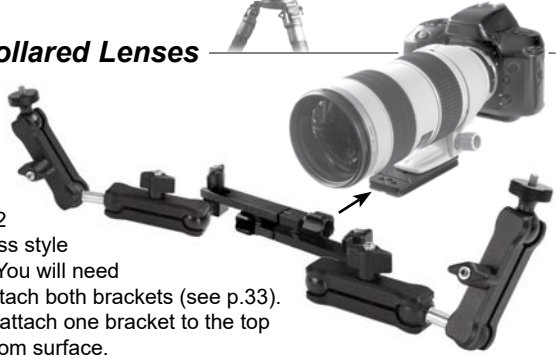

Note: requires the use of an off-camera shoe cord or wireless flash and the AP-7 Cold Shoe

Dual Flash Macro Setup: Camera Bodies

For this setup you will need:

- Two F-2 Macro Brackets
- P-5 Camera Body Plate
- M-8 Perpendicular Plate

In order to use two flashes with your camera body, you must attach a P-5 Camera Body Plate (or an L-bracket from Kirk or RRS), and the M-8 Perpendicular Plate (see below). This gives you a dovetail that is large enough, and oriented in the proper direction, to accept multiple flash brackets. Attach two F-2 Macro Brackets to the Perpendicular Plate to complete the setup.

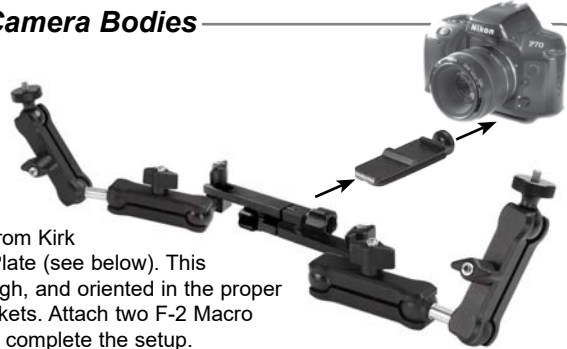

Note: requires the use of an off-camera shoe cord or wireless flash and the AP-7 Cold Shoe

M-8 Perpendicular Plate (\$85.00)

The M-8 Perpendicular Plate attaches to the Arca-Swiss style camera body plate (P-5 or similar, or L-bracket) on your camera body. It gives you a dovetail plate that is parallel to the axis of the lens. **The M-8 flash bracket module allows for multiple uses:**

1. The attachment of single or multiple F-2 Macro brackets to your camera body (see above).
2. Making small forward and backward adjustments for macro photography.
3. The attachment of your camera (with non-collared lenses) to the Wimberley Head for landscape work (see p.5).



Flash Brackets (continued)

Other Flash Bracket Applications

Quick-Flip Portrait/Wedding Bracket

This setup attaches to your camera body and allows you to flip your flash so that it is elevated above the lens for both horizontal and vertical shots. Keeping the flash above the lens reduces red-eye and distracting shadows. This setup is useful for candid portrait shots and wedding photography.

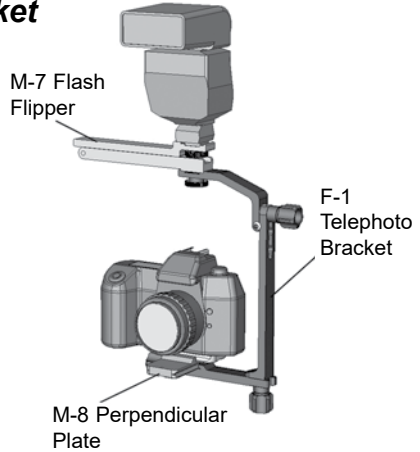
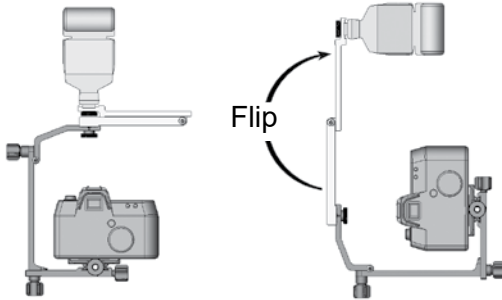

For this setup you will need:

- F-1 Telephoto Bracket
- M-8 Perpendicular Plate
- M-7 Flash Flipper

Note: requires the use of an off-camera shoe cord or wireless flash and the AP-7 Cold Shoe

Bean Bag Support Setup (bean bag not included)

This setup consists of two M-1 Quick Release Arms. Connect both arms (pointing in opposite directions) to your Arca-Swiss style lens plate to form a snowshoe-like foot that prevents lens "roll". This setup increases stability and makes it easier to rotate your lens via the collar when working from a bean bag. Since these modules are part of the flash bracket system, adding flash is a breeze!

For this setup you will need:

- An Arca-Swiss style lens plate on your lens
- Two M-1 Quick-release Arms

Note: If you buy any bracket that already contains module M-1 you can simply purchase an extra module M-1 to give you this option.

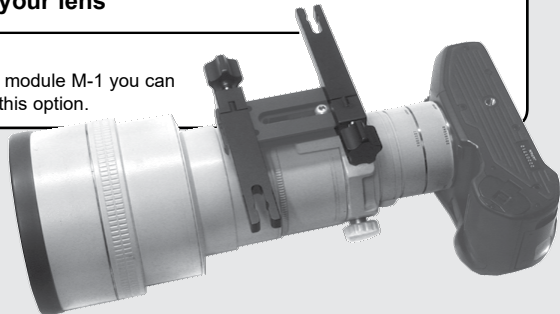

"We've tried many different systems over the years to maximize lens stability upon a bean bag, and both Mary and I agree that the best system we've used was the one we adopted this year -- Wimberley's Quick-release Arms."

-Joe McDonald

Flash Bracket Quick-release Tutorial

Lens Plate Attachment

Wimberley brackets can be attached to the bottom of any Arca-Swiss style lens plate.

For Wimberley Lens Plates

If you are using Wimberley lens plates (p.16), you also have the option of attaching your flash brackets to the top surface of the plate. This is advantageous because it ensures that the flash bracket will not interfere with the quick-release clamp on your tripod head.

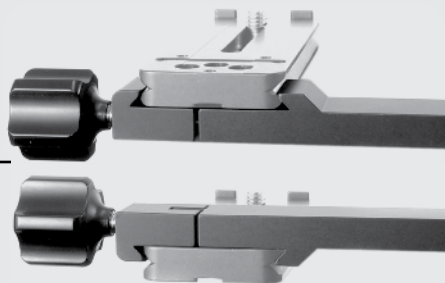

Length Requirements for Non-Wimberley Lens Plates

Wimberley Flash Brackets will attach to the dovetail of Arca-Swiss style plates, but the plate must be long enough so that a portion of the plate's dovetail is available when the plate is safely clamped in the quick-release clamp of your tripod head. *Your plate should extend at least 1/2" past the centerline of the quick-release clamp to ensure that it is safely clamped (see right).* **You must also have 3/4" of plate exposed beyond the end of the clamp for the flash bracket to grab.**

Note: These are the absolute minimum requirements. If you are not comfortable with these dimensions, you may want to switch to a suitable Wimberley plate. Note that attaching the flash bracket to a relatively short plate limits backward and forward adjustment. This is particularly problematic when using a gimbal head, where precise balance is crucial.

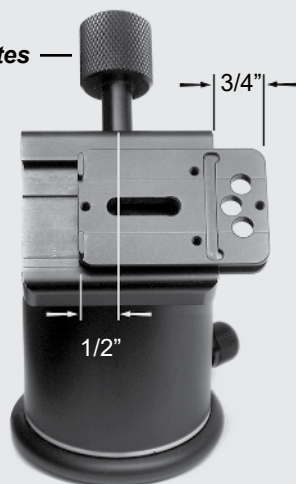

AP-11 Dovetail Adapter Plate (\$19.00) (For non-double-dovetail RRS and Kirk Plates)

Adding the AP-11 to older RRS or Kirk lens plates allows you to attach Wimberley flash brackets to the top surface of the plate. Your plates must have holes

to accept non-quick-release RRS or Kirk flash brackets, and you must have at least 5/8" clearance between the top of your existing plate and the barrel of your lens.

Important Note: The AP-11 is not compatible with the following Kirk Replacement Feet: LP-47, LP-46, LP-50 & LP-53.



Camera Body Plate Attachment

The F-2 Macro Bracket can be attached directly to an Arca-Swiss style camera body plate. Length requirements are the same as those for lens plates (see above).

If your camera plate is too short, add the M-8 Perpendicular Plate (p.31). This plate also allows you to attach telephoto brackets and multiple macro brackets to your camera body.



The Plamp® Family

What we began in 1998 with the original Plamp has blossomed into a full mobile macro studio.

Each member of the family is designed to be compatible with each other. This makes it easy to combine them and easily adapt and articulate your setup for whatever shot you are making.

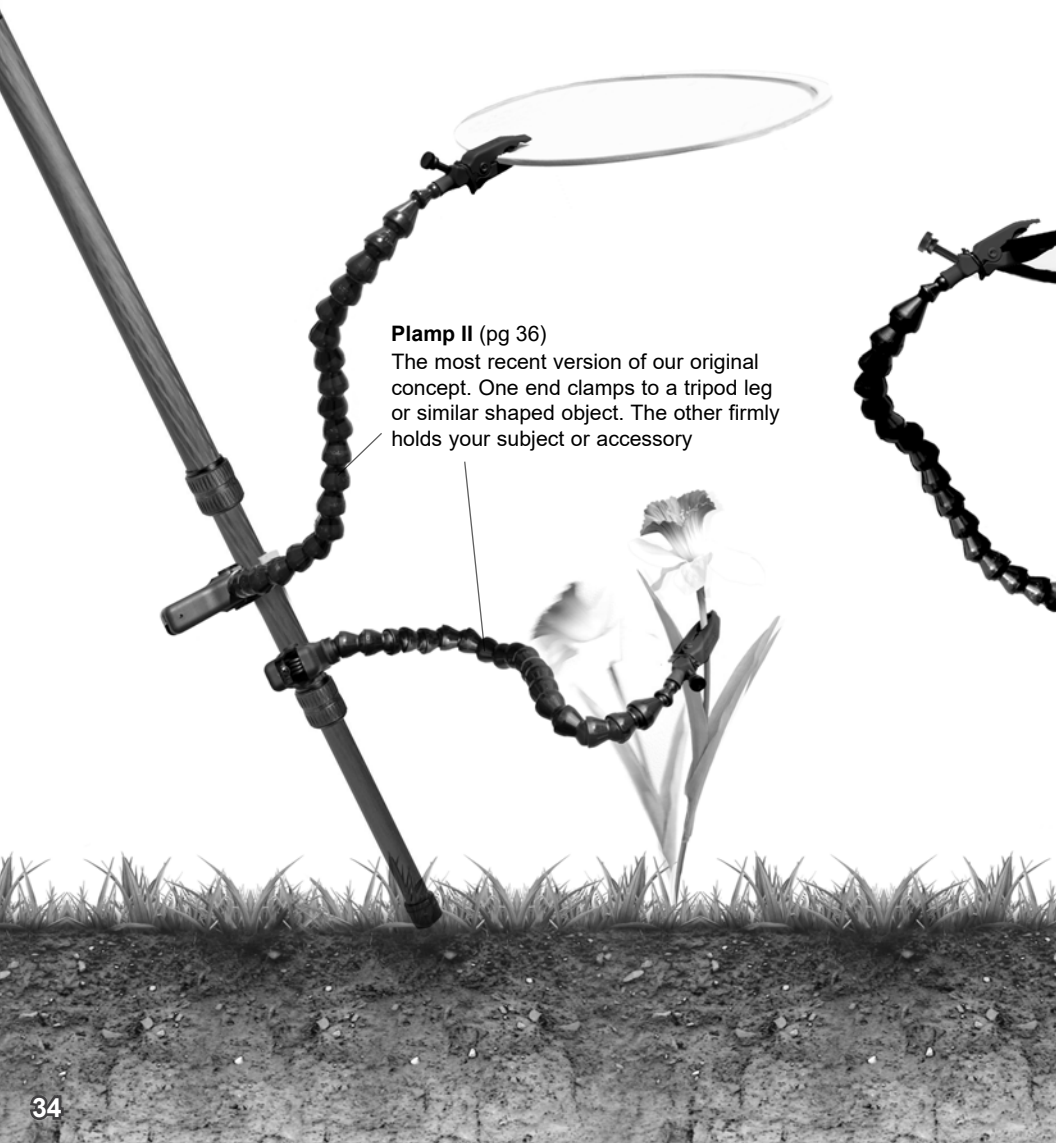

Plamp II (pg 36)

The most recent version of our original concept. One end clamps to a tripod leg or similar shaped object. The other firmly holds your subject or accessory

"The Plamp is a macro photographer's dream come true. Working with the Plamp is like having an assistant in the field."

-Nancy Rotenberg

"I consider the Plamp to be a necessary piece of equipment for serious wildflower photographers and recommend it highly."

-Joseph K. Lang

"The Wimberley Plamp is a very useful tool that always travels with me in the field."

-George Lepp

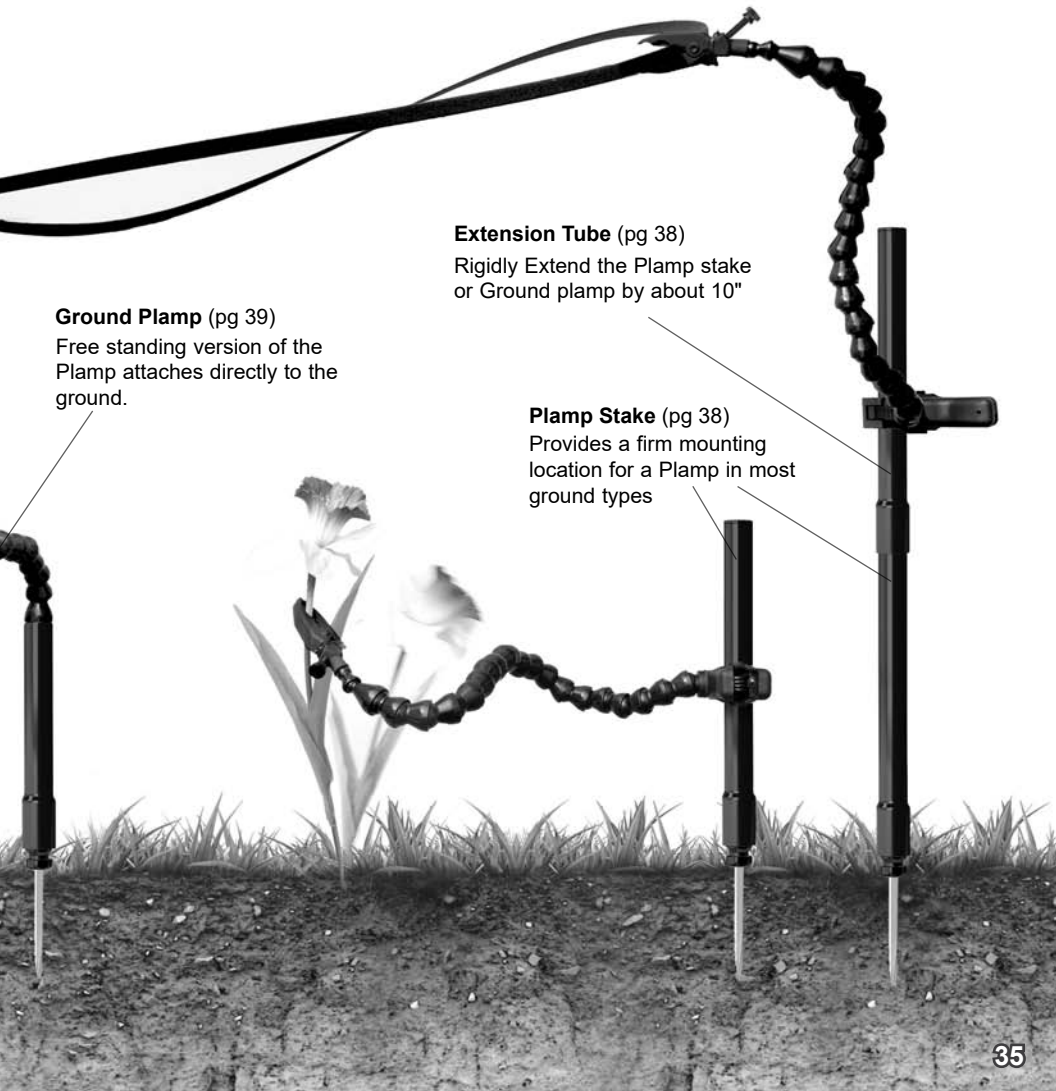

Ground Plamp (pg 39)

Free standing version of the Plamp attaches directly to the ground.

Extension Tube (pg 38)

Rigidly Extend the Plamp stake or Ground plamp by about 10"

Plamp Stake (pg 38)

Provides a firm mounting location for a Plamp in most ground types

The Plamp II

PP-200 (\$49.00)

Weight: 7.9 oz

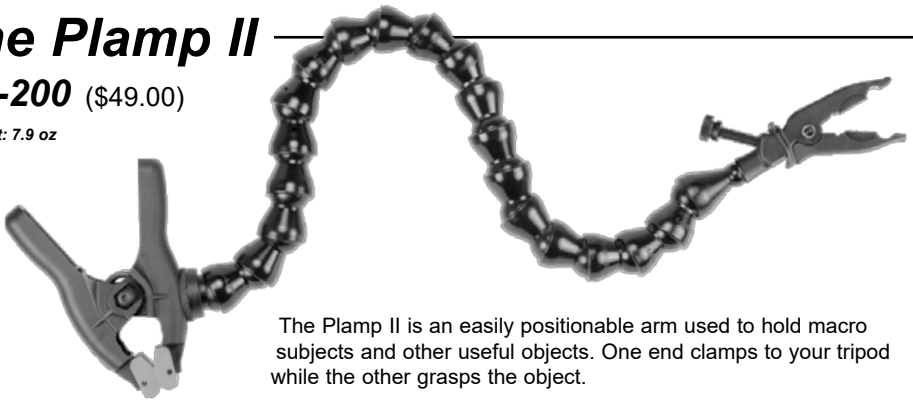

The Plamp II is an easily positionable arm used to hold macro subjects and other useful objects. One end clamps to your tripod while the other grasps the object.

Use the Plamp to stabilize windblown subjects, adjust the position or angle of your subject, or move obstructing foliage. You can also use the Plamp to hold reflectors, diffusers and small flashlights. One day in the field with a Plamp and you will begin to realize its full potential!

The Plamp II improves significantly upon the design of the original Plamp by incorporating a more robust articulating arm and a completely redesigned clip. The Plamp II allows you to confidently hold anything from the most delicate plant stems to heavy reflectors and diffusers.

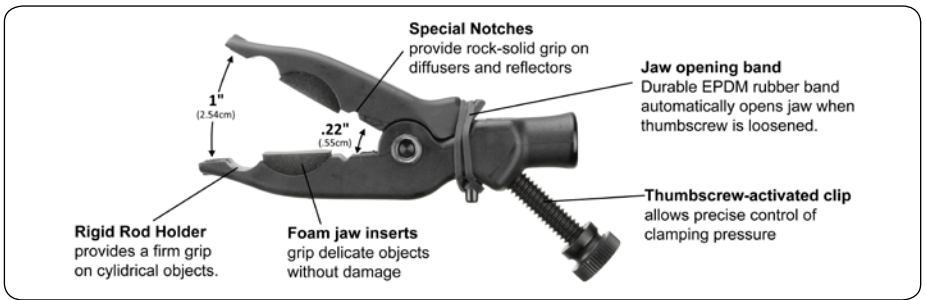

Plamp Accessories

The Plamp Extension Rod

PP-210 (\$25.00)

The Plamp Extension Rod allows fine placement adjustment and also extended reach for your plamp. The Extension Rod consists of the Plamp II Clip and a carbon fiber rod that is designed to slide easily in the Plamp Clip.

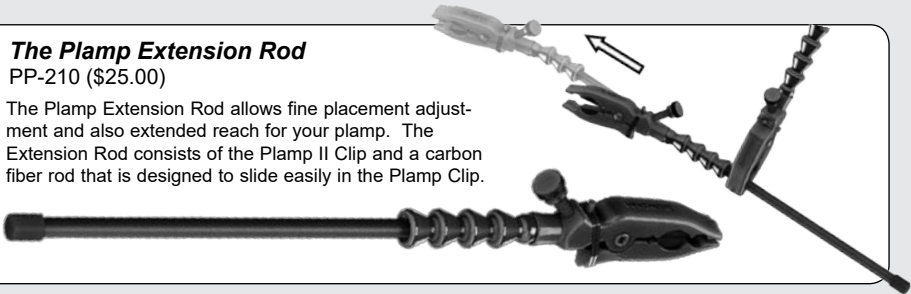

Thumb Screw Clip

PP-211 (\$14.00)

Retrofit your old PP-100 Plamp with the redesigned clip. This will not work on the newer PP-200.

If you need a replacement clip for a new Plamp, please contact us.



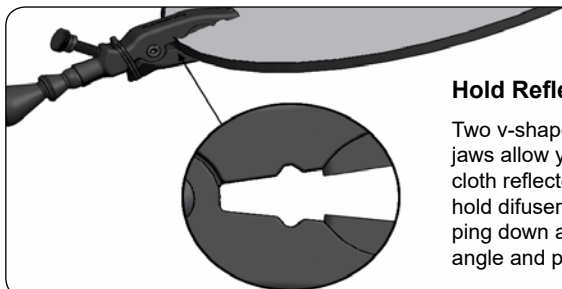

Hold Reflectors with Authority!

Two v-shaped notches at the back of the clip's jaws allow you to firmly grip the metal ring on cloth reflectors and difusers. This allows you to hold difusers above your subject without flopping down and gives you precise control of the angle and position of reflectors.



The Plamp Stake PP-300 (\$19.00)

(See Details on page 38)

The Plamp Stake can be anchored in a wide variety of ground types, creating a stable, stand-alone pole for attaching your Plamp. This opens up new creative possibilities and isolates your subject from unwanted vibrations and movements coming from your tripod and camera.

Large Diameter Extension

PP-222 (\$8.00)

Made from the same large diameter Loc-line used in the Plamp II. This product extends the length of your Plamp II by 12".



The Plamp Stake PP-300 (\$25.00)

The Plamp Stake can be anchored in a wide variety of ground types, creating a stable, stand-alone pole for attaching your Plamp. This opens up new creative possibilities and isolates your subject from unwanted vibrations and movements coming from your tripod and camera.

The Plamp Stake consists of two components: The Ground Spike and the Extension Tube. The modular nature of the design makes it easy to add height extensions, and allows the Plamp Stake to transform into a compact assembly for storage.

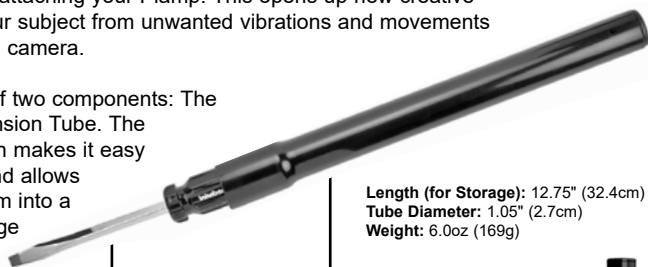

Length (for Storage): 12.75" (32.4cm)
Tube Diameter: 1.05" (2.7cm)
Weight: 6.0oz (169g)

Ground Spike

PP-310 (\$15.00)



The Ground Spike is a custom-designed screwdriver, designed specifically to serve as the anchor for the Plamp Stake. It's high-strength steel shank and ergonomic handle allows you to penetrate even the toughest ground without damaging it (or your hands). A slotted screw allows you to adjust how tightly the handle fits into the socket of the Extension Tube.

Extension Tube

PP-320 (\$10.00)

The Extension Tube is a rigid plastic tube with a flared end that fits snugly on the handle of the Ground Spike. Multiple extensions may be connected in series to achieve the desired height. (Each one adds about 10" of height.) You can also use 3/4" Schedule 40 PVC pipe with a standard belled end or coupling fitting.



Stow-Away Design



For storage, simply reverse the Ground Spike. This makes the unit more compact and keeps debris stuck to the spike contained in a protective sheath.

12.75"
(32.4 cm)



The Ground Plamp PP-400 (\$49.00)

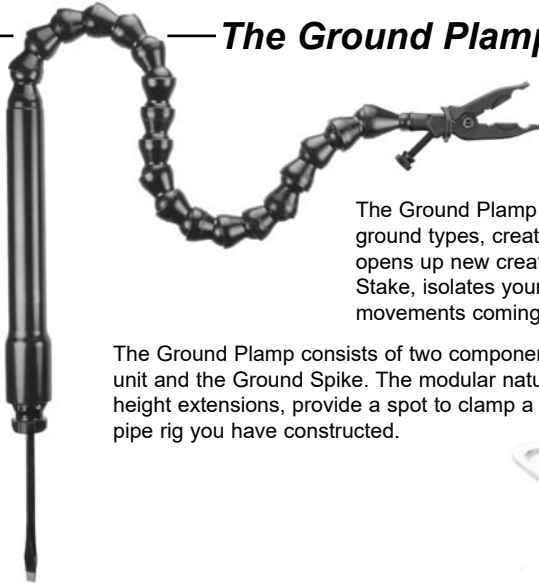

The Ground Plamp can be anchored in a wide variety of ground types, creating a stable, stand-alone Plamp. This opens up new creative possibilities, and like the Plamp Stake, isolates your subject from unwanted vibrations and movements coming from your tripod and camera.

The Ground Plamp consists of two components: The integrated plamp and sheath unit and the Ground Spike. The modular nature of the design makes it easy to add height extensions, provide a spot to clamp a plamp, or add a plamp to any 3/4" PVC pipe rig you have constructed.

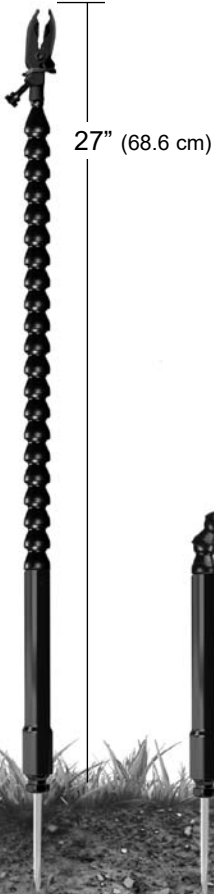

27" (68.6 cm)

The Ground Plamp can be used as an anchor point to attach additional Plamps

Extend the height of the Ground Plamp with a PP-320 Extension Tube (pg. 38).

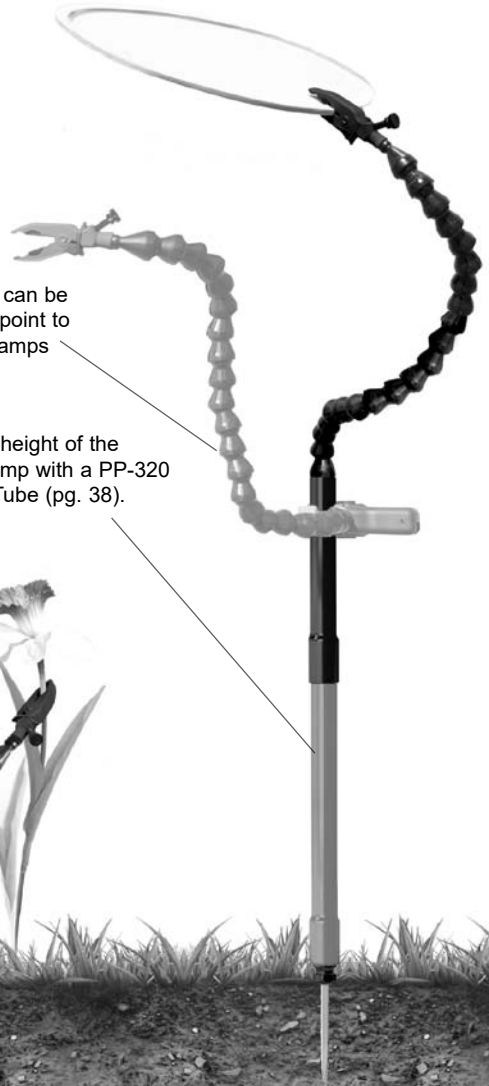

Plamp Hardware

KY-PP-201 - Plamp Thumbscrew Clip Tension Adjust Key (\$2.00)

This tool is not necessary for normal use of the plamp. The Plamp clip is designed to rotate relative to the articulating arm with slightly less resistance than is found between similar arm segments. If you desire this resistance to be higher or lower, you may accomplish this by adjusting the Torx 20 mounting screw.

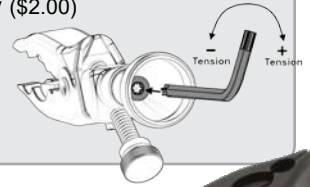

PP-211-1420 - 1/4"-20 Threaded Plamp II Thumbscrew Clip (\$15.00)

This is the standard Plamp II thumbscrew clip with a brass female 1/4"-20 mounting socket.



LL-PP-203 - 1/2" to 1/4" Loc-Line Adapter (\$4.00)

This is a 1/2" Female to 1/4" Male Loc-line reducer adapter



LL-PP-204-1420 - 1/2" Loc-Line Fixed Mount with 1/4"-20 Socket (\$5.00)

This is a 1/2" Loc-line Fixed mount adapter with a brass female 1/4"-20 mounting socket.



LL-PP-204-T - 1/2" Loc-Line Fixed Mount with 1/4" Through Hole and rubber washer (\$5.00)

This is a 1/2" Loc-line Fixed mount adapter with a brass female 1/4"-20 mounting socket.

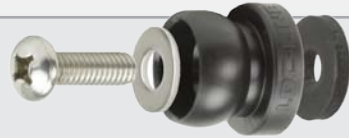

LL-PP-205 - 1/2" to (2) 1/4" Reducer Tee Loc-Line Adapter (\$4.00)

This is a 1/2" Female to two 1/4" Male Reducer Tee fitting



LL-PP-206 - 1/2" Magnetic Loc-Line Fixed Mount Base (\$15.00)

This is a 1/2" Loc-Line fixed mount attached to a heavy duty magnetic disk



Other Hardware and Fasteners

SW-100 Extra Screw (\$1.00)

1/4-20 x 1/2" (.5) Custom Stainless Captive Hex Button Head Cap Screw (5/32" hex drive)

For lenses that require more screws than are included with plate.

See p.14 for the number of screws included with each plate.

(Note: screw is not compatible with the P-5 Camera Body Plate.)



SS-100 Spotting Scope Screw (\$1.00)

1/4-20 x 7/16" (.44) Custom Stainless Captive Hex Button Head Cap Screw (5/32" hex drive)

For lenses that require a shorter screw like spotting scopes and some Leica lenses

(Note: screw is not compatible with the P-5 Camera Body Plate.)



SW-105 Camera Body Plate Screw (\$1.00)

1/4-20 x 3/8" (.37) Custom Stainless Captive Hex Button Head Cap Screw (5/32" hex drive)

A replacement screw for the P-5 Camera Body Plate.



SW-STOP-2 Extra Stop Screw (Pkg 2) (\$1.00)

M3 x 6mm Hex Socket Head Cap Screw (2.5mm hex drive)

Stop Screw for lens plates, replacement feet, camera body plate, and MonoGimbal head



SW-STOP-2S Extra Stop Screw (Pkg 2) (\$1.00)

M3 x 3mm Hex Socket Head Cap Screw (2.5mm hex drive)

Stop Screw for lens plates, replacement feet, camera body plate, and MonoGimbal head

Shorter length is used on the SK-100 and AP-500, but will work on any our products.



BS-100 Brass Reducer Bushing (\$3.00)

Lens feet with 3/8" mounting holes require insertion of a 3/8" to 1/4" reducer bushing.

Our P-40 and P-50 lens plates come with a brass reducer bushing included in the kit.

There is no need to order an additional bushing unless your lens foot has more than one 3/8" size hole. See p.16.



If you need a replacement fastener or adapter not seen on these pages, feel free to contact us.

About Our Company

Wimberley, Inc. is a father-son partnership dedicated to the design and manufacture of professional photography equipment. Since our beginning in 1991, we have been committed to making high-quality, innovative products and providing our customers with exceptional customer support. Our products are made in the USA.

Our **60-Day Unconditional Money-back Guarantee**, **10-Year product warranty**, and try-before-you-buy **Test-Drive Program** reflect the confidence we have in our products and in the customers who buy them.

Thank you for your interest in our products, and best of luck in the field.



Photo by Clay Wimberley

Business Hours:

We are open for business 9 AM to 5 PM Eastern time. If you are in the area, please visit us if you wish; we would be happy to help you with equipment issues and to provide a tour of the facility.

Ordering:

Orders can be placed online through our secure website or by phone. We accept all major credit cards, money orders and personal checks (USA only). Our Customer Service Team is happy to personally assist you with your purchasing decisions.

Shipping:

Orders received before 1:00 pm Eastern Time will be shipped the same day. If you have a shoot coming up and need equipment delivered to a particular location within a specific timeframe, please let us know and we will try to make that happen.

We ship orders primarily via Fed-ex 2-day service and USPS Priority mail. Shipping is free to USA addresses except for orders under \$100 which ship at a flat \$5 rate. Customers may also select and pay for UPS Ground service or an expedited service such as Next Day Air, 2nd Day Air or 3-Day Select Guaranteed. If you need us to ship-to a different address than the bill-to address, please contact us first. We will be happy to ship your order to a hotel or workshop address.

International customers: Delivery services vary from country to country. Please refer to the **About Ordering** section of our website for details, or contact us for a price quote.

10-Year Product Warranty: *(for all purchases of new Wimberley equipment)*

All Wimberley Products are covered with a 10 Year product warranty against manufacturing defects and product malfunction during normal use.

60-Day Money-Back Guarantee: *(Direct from Wimberley, Inc purchases only)*

Products purchased directly through Wimberley, Inc. are covered by a 60-day money back guarantee. If you wish to return an item for any reason, please contact our office for a Return Authorization *before* sending it in.

Test-Drive Program: *(U.S.A. residents only)*

See first-hand how our products work with your equipment. U.S. residents can test-drive Wimberley products (new or used), free of charge, for up to 60 days. Call us with a list of your gear, and we will assist you in selecting the proper lens support and accessories to field test with your set up.

Note: A valid credit card must be left on file to participate in this program.

Contact us:

Feel free to contact us. We are always glad to assist with your photography needs.

Email: info@tripodhead.com

Phone: 1-888-665-2746 (toll free US & Canada)

Website: www.tripodhead.com

Wimberley

Wimberley, Inc.

www.tripodhead.com

info@tripodhead.com

1750 Broadway Street
Charlottesville, Virginia 22902, USA
Phone: 1-434-529-8385
Toll-free (*USA & Canada only*): 1-888-665-2746

Revised 7/12/2023

Copyright © 2020 Wimberley, Inc. - All Rights Reserved

