

About The CK-550

The **CK-550 Conversion Kit** allows you to replace the low-profile, round knob (shown in Fig. 1) on the tilt mechanism of older Sidekicks and Wimberley Head models (WH-100 & WH-101) with the 5-lobe, soft-touch tilt knob found on the current Sidekick and Wimberley Heads. The procedure is simple, and the only tool required is a Phillips screwdriver. The screw provided in this kit should fit most units; however if you experience a problem upon installation, please contact us. Please read these instructions carefully; make sure that you remove the appropriate parts from your existing unit and install the new parts in the proper order.

NOTE: The screw in this kit is too long for installation on the Wimberley Head Version II & the Sidemount Head tilt. If you need to replace knobs on either of these Heads, please contact us. **This knob is not compatible for the replacement of the panning knob on any unit.**

Dimensions (L x W x H): 1.8" x 1.9" x 1.1"

Weight: 1.2 oz

Materials: Rubber, plastic, brass, aluminum, stainless steel

Instructions

Note: The drawings below show the Wimberley Sidekick®, however the same steps and hardware apply for retrofitting the tilt knob on original style Wimberley Heads, models WH-100 and WH-101.

Removing Your Existing Knob

1. **Remove the captivating screw** (the screw that keeps the knob from backing all the way off) using a Phillips screwdriver as shown below.
2. **Unscrew the knob**, and be careful to keep the remaining parts in place. Once the knob is removed, there is nothing keeping the shaft from sliding out of the bearing housing; **be sure the mechanism is held together until the new knob is installed.**

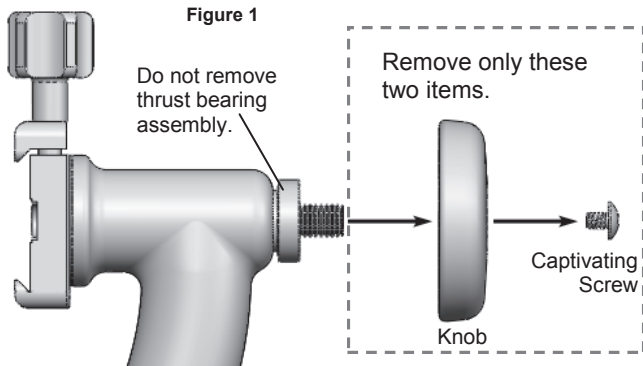

Wimberley™

CK-550

Soft-Touch Knob Conversion Kit

Tilt Knob for Sidekicks & Wimberley Head models WH-100/101



Made in USA

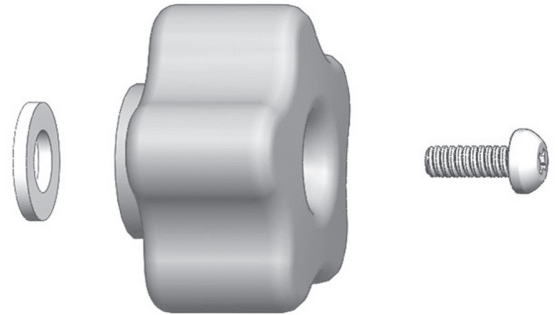

Package Contents:

- **Knob:** Five-lobed, soft-touch Knob (Qty 1)
- **Washer:** Aluminum Spacer Washer (Qty 1)
- **Mounting Screw:** 10/24 x 5/8" Phillips Pan Head (Qty 1)

Wimberley, Inc.

974 Baker Lane
Winchester, VA
22603 USA

Phone: 1-540-665-2744

Toll Free: 1-888-665-2746 (USA & Canada)

www.tripodhead.com

info@tripodhead.com

Installing the New Knob

1. **Install the aluminum washer** on the shaft.
2. **Install the new knob** (oriented as shown in the diagram).
3. **Install the new, longer captivating screw** using a Phillips screwdriver. Drive the screw in until it bottoms out in the threaded hole. If this screw position does not allow the knob to be backed out at least one-half turn, back the captivating screw out a small amount.

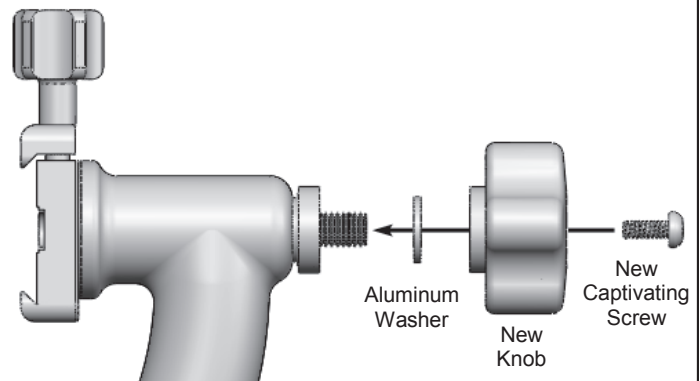

Thank you for your interest in Wimberley products.

If you have any questions or comments please feel free to contact us (our contact information is located in the black box on this page).